



Toll Brothers
APARTMENT LIVING

**ROCKWOOD
DEVELOPMENT**

Barbee Chapel Apartments

Town Council
May 24, 2023



Barbee Chapel Apartments



Toll Brothers
APARTMENT LIVING

ROCKWOOD
DEVELOPMENT



Barbee Chapel Apartments

Council Comments at April 19 Meeting

What we heard from Town Council:

- Reduce Parking
- Decrease Impervious Surface
- Improve Stormwater Management
- Increase Affordable Housing Options

Draft

Barbee Chapel Apartments

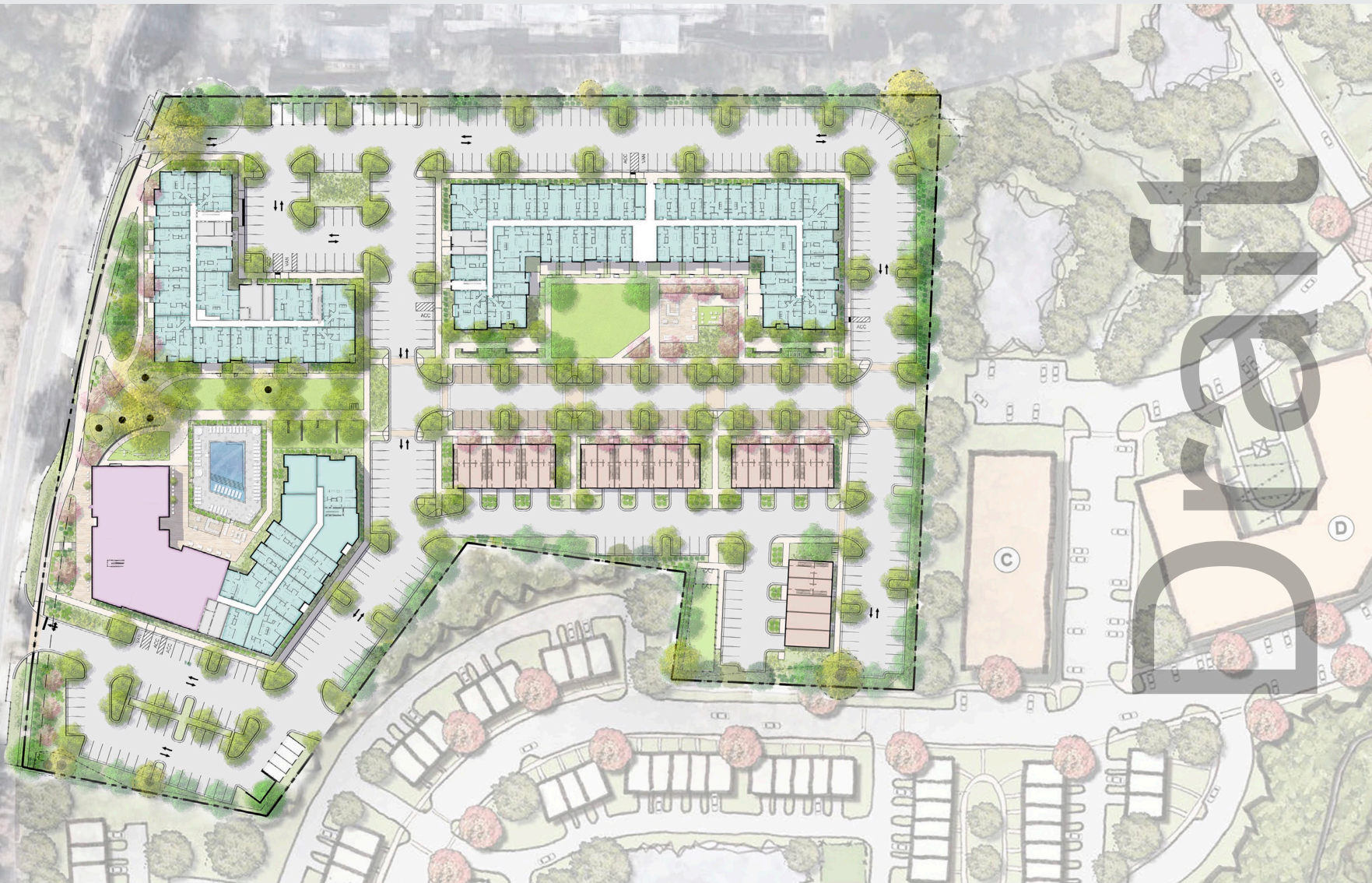

Barbee Chapel Apartments

Updates to Site Plan

- **Reduce Parking**
 - ORIGINAL: 495 total spaces
(1.4 spaces/unit)
 - REVISED: **49 FEWER spaces**, or 446 total spaces
(1.3 spaces/unit)
 - Converted Parking Spaces to Tree Islands along “main street”
 - Decreases impervious surfaces
 - Allows for larger tree species
 - Increases shade / reduces heat island effect
 - Supports campus-like feel

draft

Barbee Chapel Apartments

Updates to Site Plan

- **Decrease Impervious Surfaces**
 - More Pervious Surface, in part because of converted parking spaces
 - Added Permeable Surface along parts of the “main street”
- **Improve Stormwater Management**
 - Committing to installing infrastructure for 50-year storm event (vs 25-year event required by ordinance)

Barbee Chapel

Barbee Chapel Apartments



Barbee Chapel Apartments

Affordable Housing Plan / Options

Original Proposal:

- **Affordable Units:** 31 units
 - 15 units at 65% AMI
 - 16 units at 80% AMI

Council Feedback:

- Not enough affordable housing and wanted to reach lower AMI
- Also, HAB's preference for including 60% AMI



Barbee Chapel Apartments

Affordable Housing Plan / Options

Two Alternate Scenarios:

** these incorporate updated HUD AMI numbers **

Alternate 1:

- **Affordable Units:** 30 units
 - 15 units at 80% AMI
 - 15 units at 60% AMI

Alternate 2:

- **Affordable Units:** 23 units
 - all at 60% AMI



