

Site Work Guidelines

The tree protection fencing and silt fencing should be installed prior to deconstruction, demolition and the grading operations and continue until all major construction and utility work has been completed.

Contact appropriate utility companies and protect existing utility connections.

Tree Protection Notes

- 1. Any tree roots exposed by construction shall be severed cleanly with a pruning tool.
2. Do not dispose of any chemicals or remove soil outside the limit of work.
3. When installing new landscape plants, do not drive equipment upon or disturb the soil within the critical root zone of existing trees.
4. A preconstruction conference must be held before any site work begins.

Construction Sequence

- 1. Obtain appropriate permits.
2. Hold preconstruction conference.
3. Erect tree protection fencing-flagging before substantial work with any equipment an/or utility work. Install soil and erosion control measures.

Limits of Construction / Site Access

(construction equipment to access site along the existing Ch Hill gravel path leading to the existing kiosk site). Do not encroach existing tree root area under canopy. Restore access path back to natural condition upon completion of project.

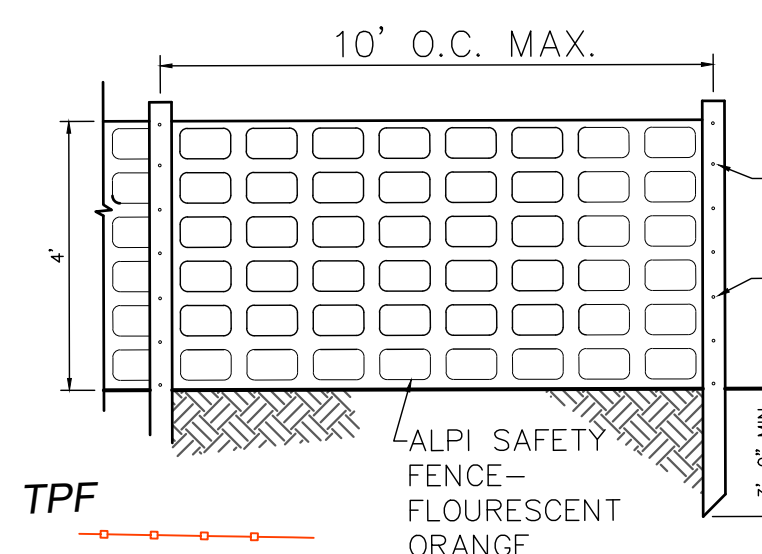

1 TREE PROTECTION FENCE ELEVATION DETAIL Not to Scale

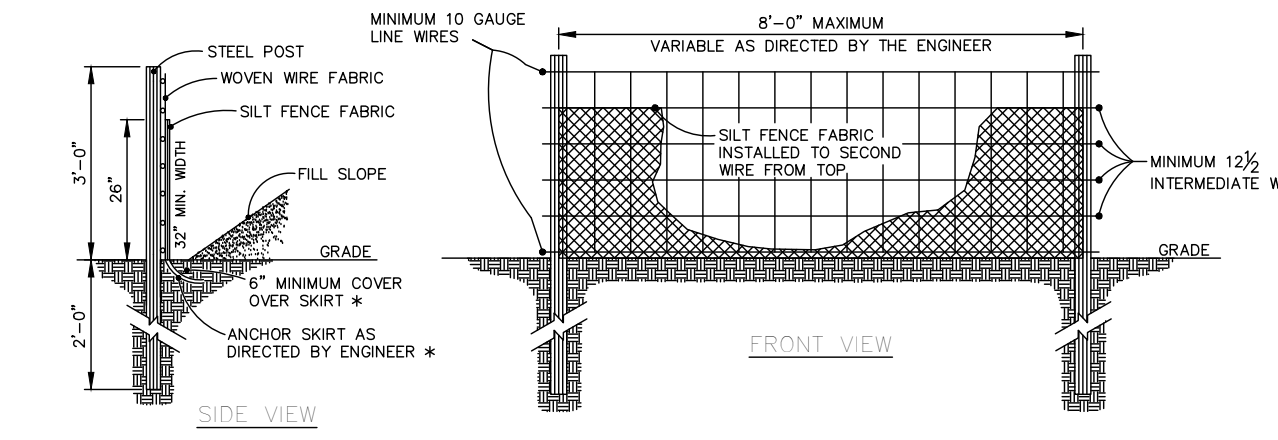

2 SILT FENCE SCALE: NOT TO SCALE



WAC 3" Inground 12V Landscape Recessed LED Order Number: 5031-27BBR

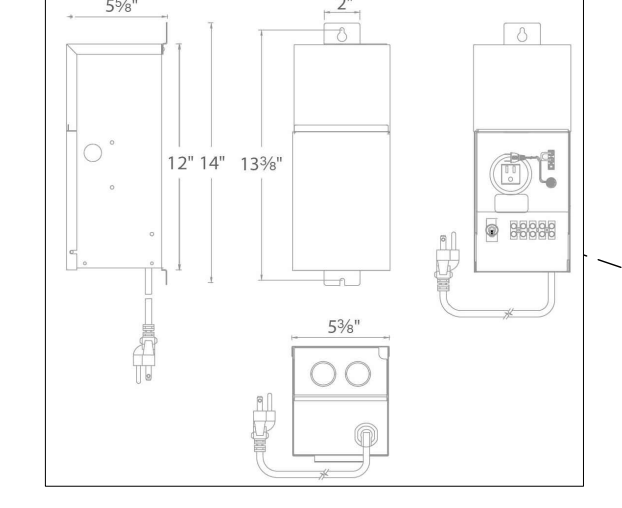

12V Magnetic Transformer 9150-TRN-SS - 150W Magnetic Landscape Lighting Power Supply in Stainless Steel

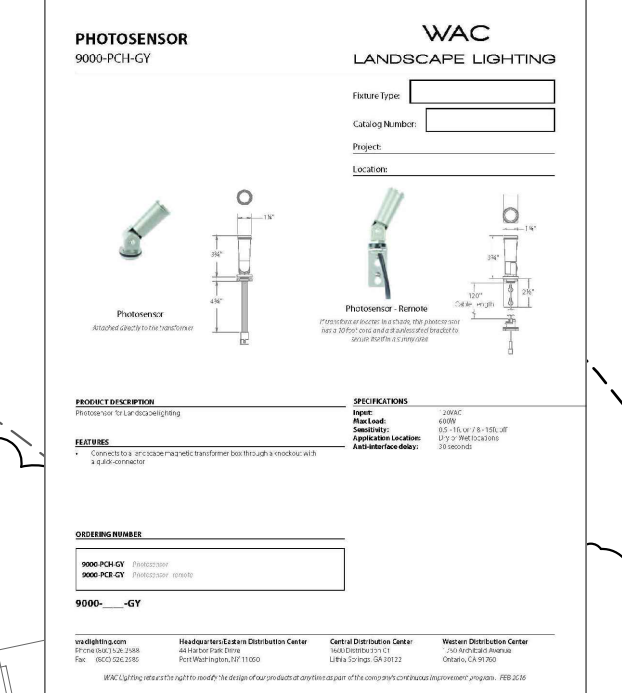

PHOTOSENSOR WAC LANDSCAPE LIGHTING

Orange County Veterans Memorial

The Ceremonial Circle the Flagpole

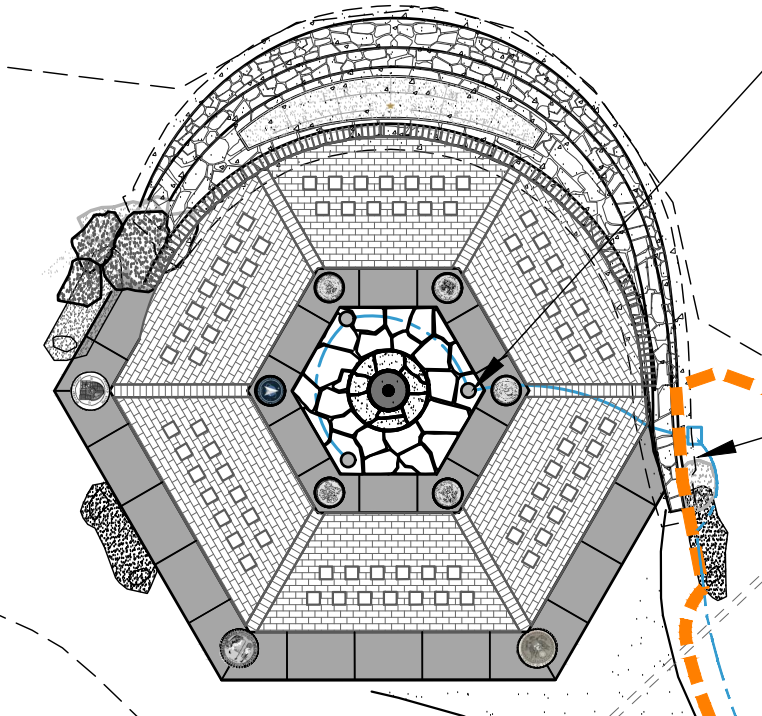

Flagpole uplights (3) - The Contractor shall provide three (3) uplights for the flagpole. Lights to be WAC 3" Inground 12V Landscape Recessed LED

with 12V Magnetic Transformer (Outdoor) Accessory 9150-TRN-SS - 150W Magnetic Landscape Lighting Power Supply in Stainless Steel and photo-voltaic and timer control.

Conduits and housing canisters were installed under the wall and paving to each of the locations shown on the plan.

Contractor to provide the fixtures and electrical connections for lighting.

Extend electrical wiring (per code) to back of stone wall by stub-outs from the new electrical connection by Duke Energy. This electrical circuit will be used for up-lighting the flagpole and outdoor electrical outlet at the Kiosk.

The Forest Grove

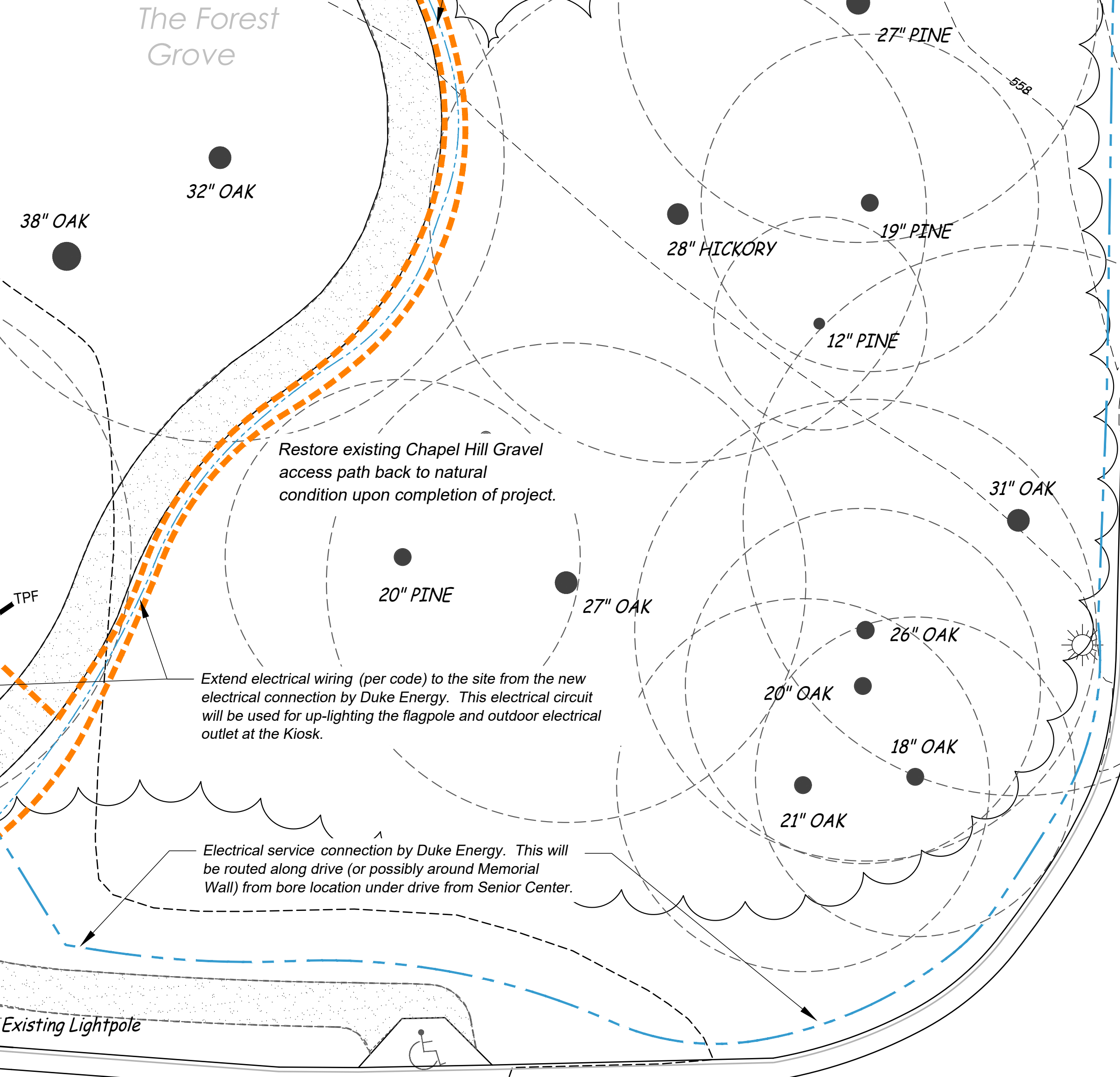

Restore existing Chapel Hill Gravel access path back to natural condition upon completion of project.

Extend electrical wiring (per code) to the site from the new electrical connection by Duke Energy. This electrical circuit will be used for up-lighting the flagpole and outdoor electrical outlet at the Kiosk.

Electrical service connection by Duke Energy. This will be routed along drive (or possibly around Memorial Wall) from bore location under drive from Senior Center.

Repair existing Chapel Hill gravel walk after use for construction access. Any damage to existing walk to be repaired to meet existing conditions prior to construction.

Staging area (stockpile materials and excavated soil material in this location). Maintain clear access for Ch Hill Bus Service and other vehicles

Daylight French Drain (end of drainage pipes) into stone dissipater and gravel filled (#57 stone) drywell. Use native stones for exposed stone at end of pipes.

Layout of Kiosk Staking and location of kiosk to be approved by Landscape Architect.

Contractor to use back parking during construction. Contractor to provide portable toilet for duration of construction work.

GENERAL NOTES:

Pre-Construction:

- 1. Location of staging area will be identified during the pre-bid conference. The existing parking area off Southern Human Service Center Drive will be used for access and construction parking for the site during the time period.
2. PROPOSED SCHEDULE: Contractor shall bring in all necessary construction materials and store on-site. Construction to begin Early Winter, 2024 (date to be determined).
3. Contractor shall verify all existing conditions and dimensions in the field.
4. Contractor to coordinate with Orange County Southern Human Services and Utility Locating Service to verify locations of underground utilities and easements.

GENERALIZED SCOPE OF PROJECT

BASE BID: By Contractor

Pre-Construction: (By Contractor)

- Install construction management signs
- Install Tree Protection Fencing and Silt Fencing during Construction.
- Removal of existing kiosk (salvage for reuse by Owner)

New Construction: (By Contractor)

- Site Preparation and Grading for kiosk site. Establish Fin. Floor Elev. to insure positive slope for drainage
- Excavate and construct concrete footings per plan. (including reinforcing, excluding post mount base hardware).
- Excavate for base, install 4" ABC Crushed stone, 1" depth screenings and construct flagstone as shown. 3/4" Polymeric sand joints
- Install Border PA Blue - Bluestone tread Thermal pattern Cut on concrete base with mortar joints and associated hardscape.
- Construct stone bench with concrete footing, CMU fill and Chatham stone to match existing Memorial.
- Install Landscape Lighting.
- Clean job site of construction materials upon completion of Hardscape Improvements. (By Contractor)

BY OTHERS - Orange County (OWNER):

- Remove selected trees (dead or dying or in way of construction). Thin and prune and tree management for existing trees to remain.
- Provide electrical stub to site from existing meters and electric transformer at Southern Human Services site. Contractor to provide junction box.
- Provide site furnishings (future site benches, signage and trash containers).

LEGEND - Site Work

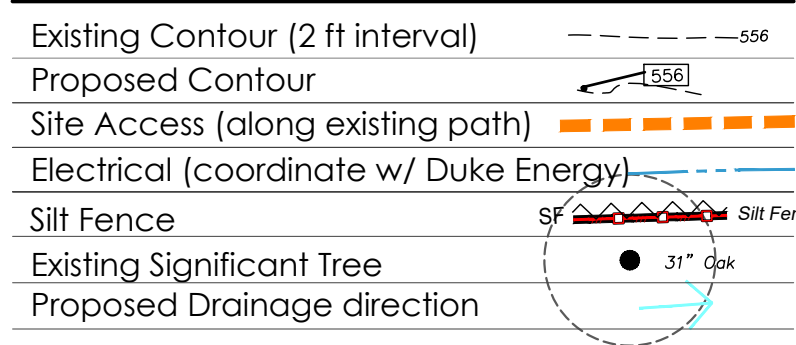

LIST OF DRAWINGS

- L - 1.0 Cover Site Context Project Summary (1"=10' scale)
L - 2.0 Kiosk Plan/Section/Elevations Details (1"=2' scale)
L - 2.1 Kiosk Details for Heavy timber Structure (1"=1' scale)
L - 3.0 Kiosk Hardscape (1"=1' scale)

Base Information Notes:

- 1. Base map information provided for site by survey by Riley Land Surveyors.
2. Contractor to confirm location of all existing features before construction.
3. Utilities to be located prior to digging.

Orange County Veterans Memorial

Orange County Southern Human Services Center

Homestead Road Chapel Hill, NC October 07, 2023

Phase 3 - Kiosk Site Plan

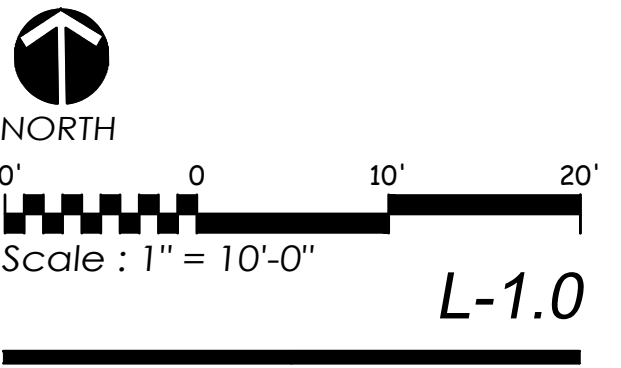

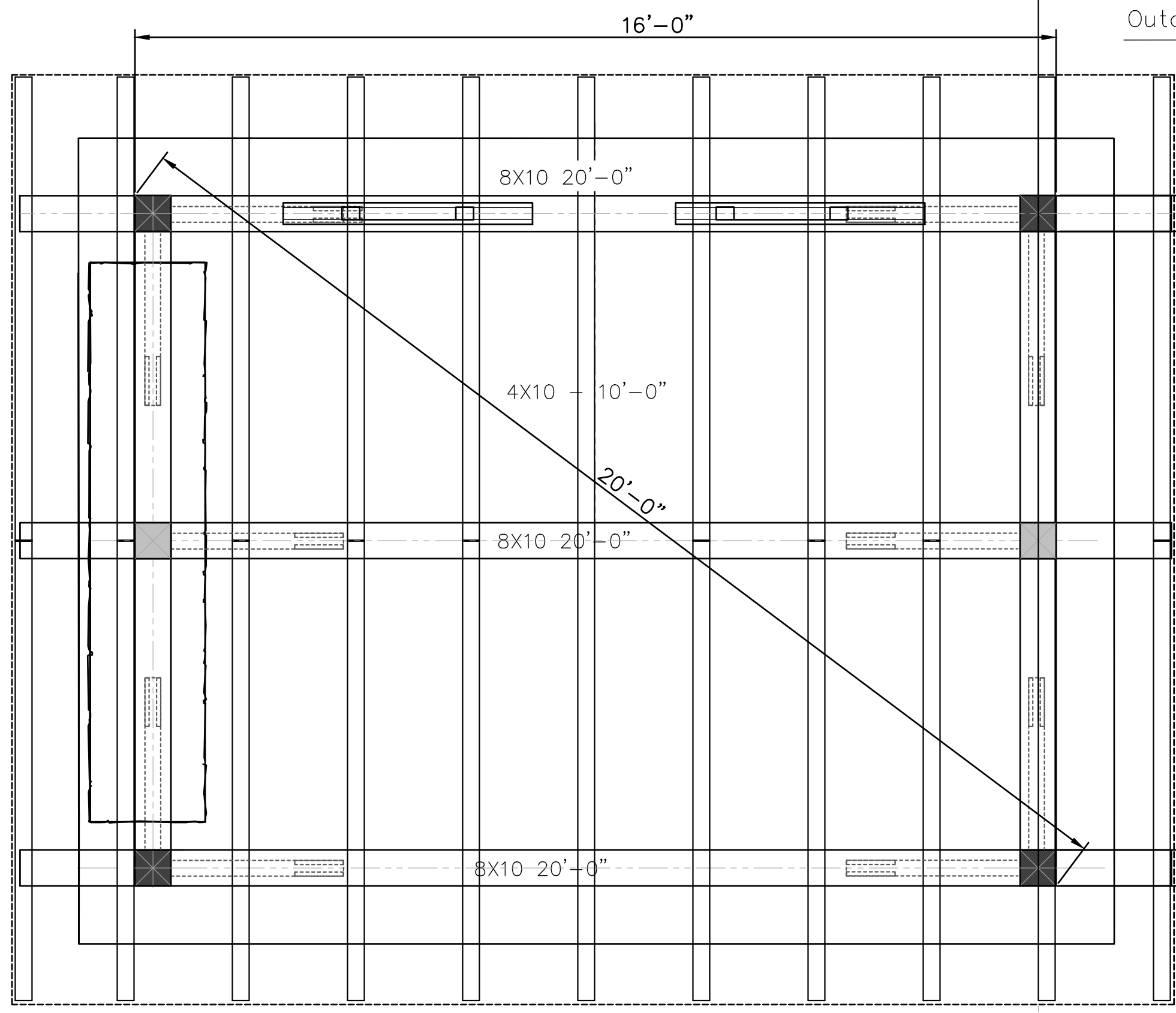

Roof Plan

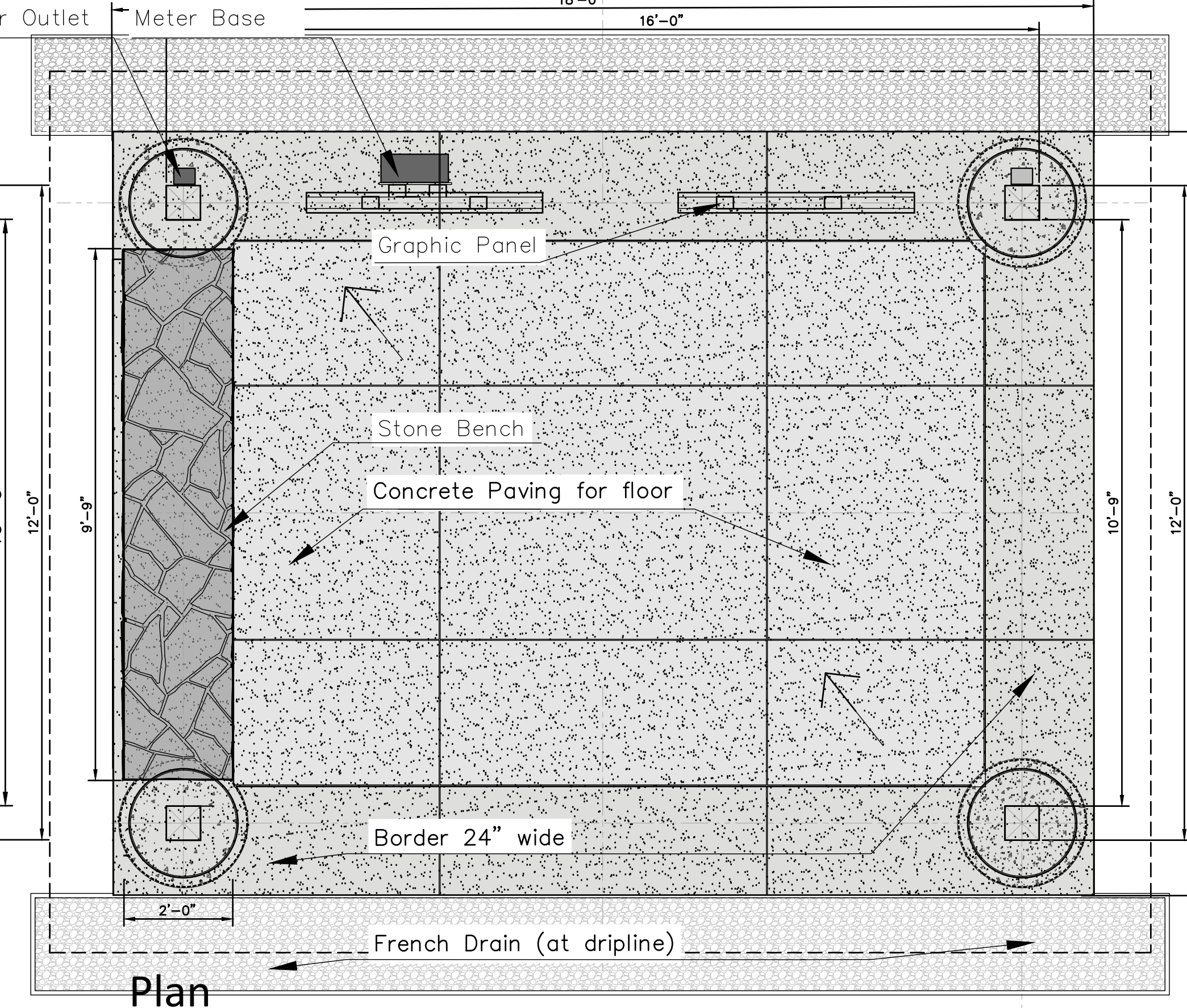

Plan

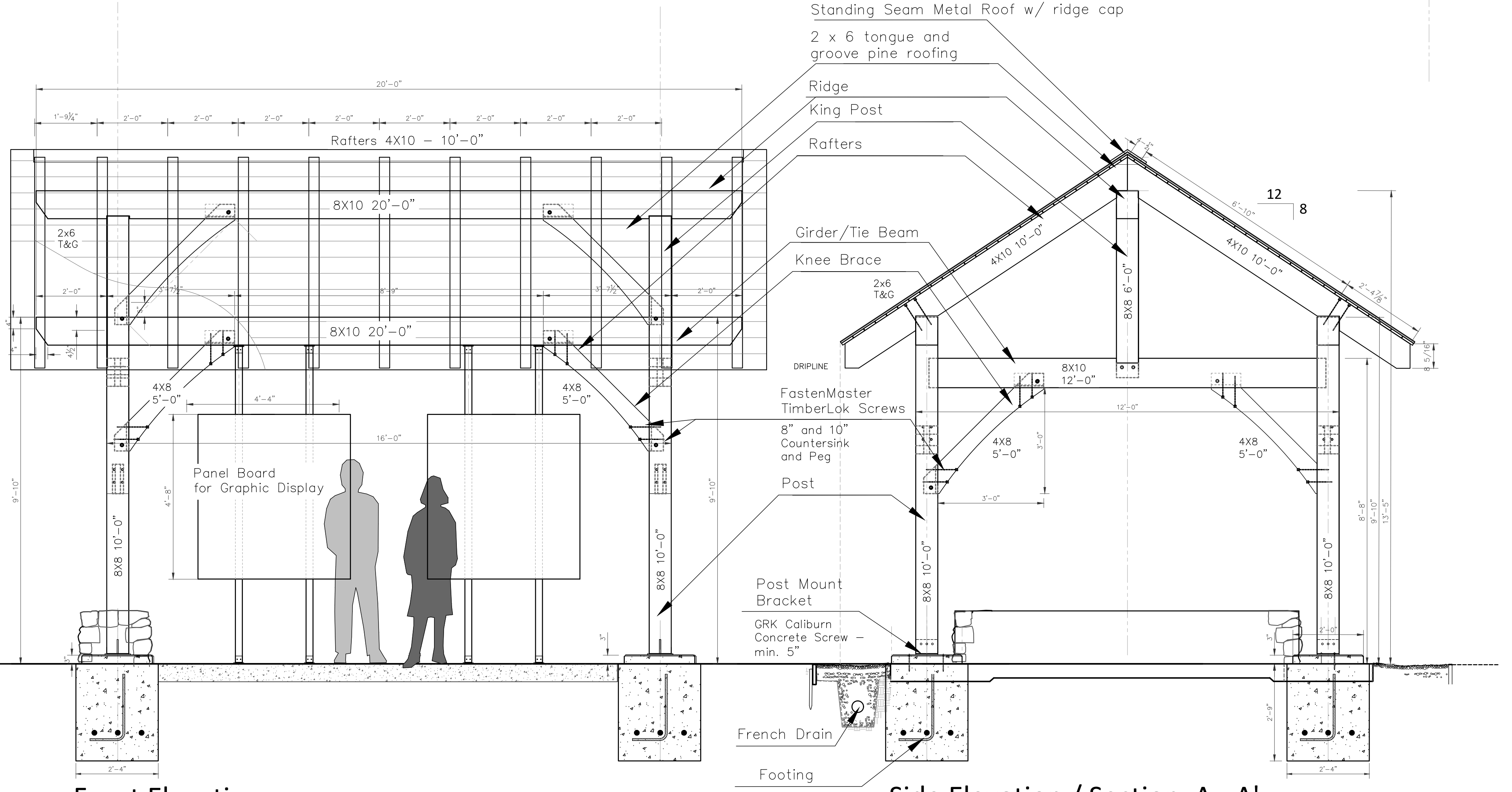

Front Elevation
Scale: 1/2"=1'-0"

Side Elevation / Section A - A'
Scale: 1/2"=1'-0"

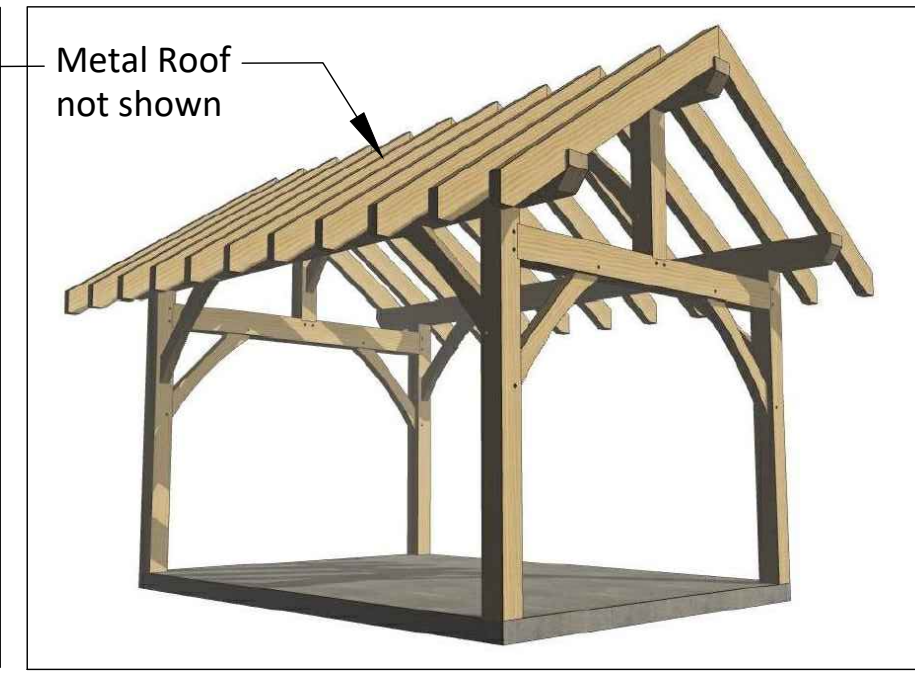
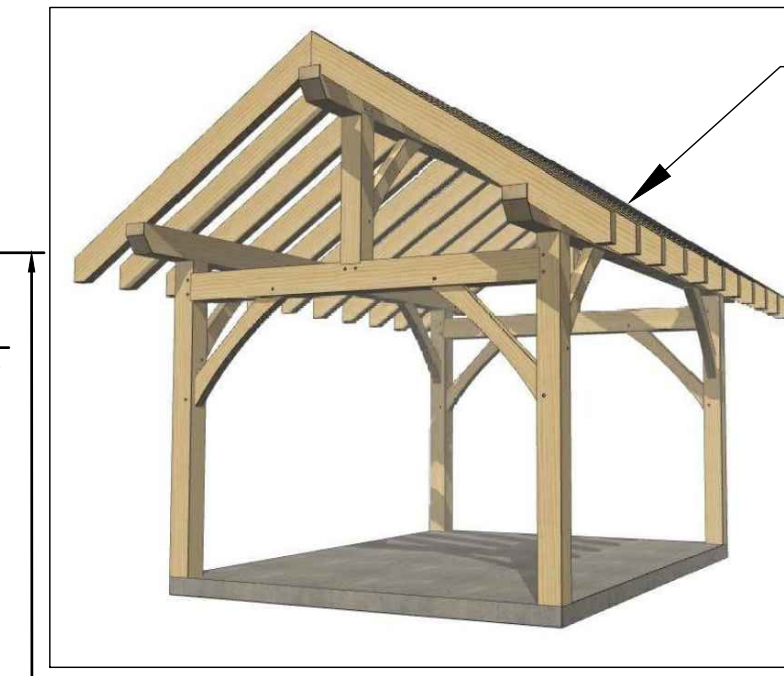

Sketch View of heavy timber framing

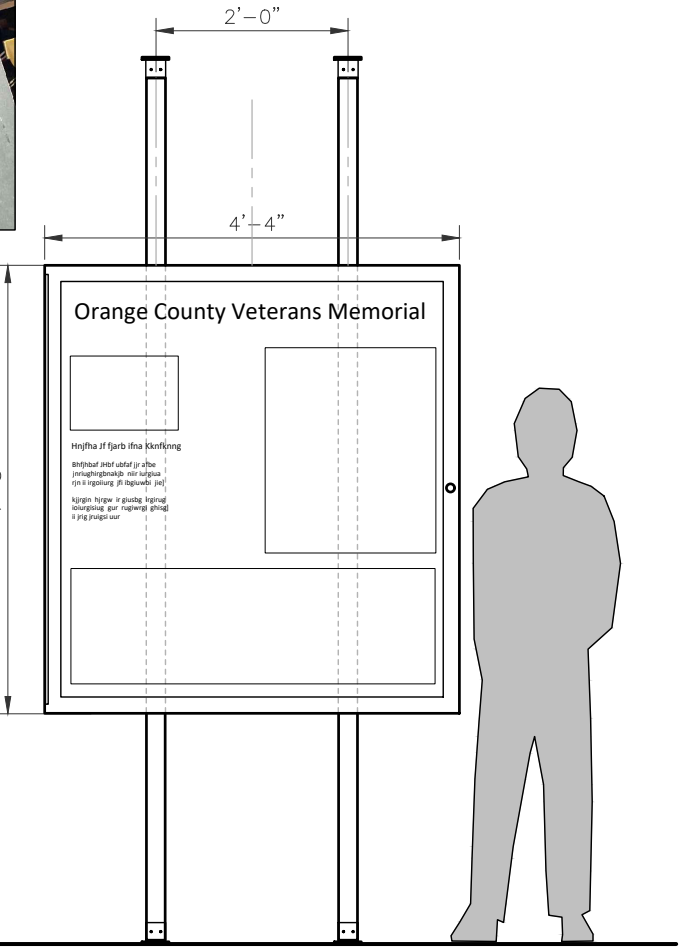
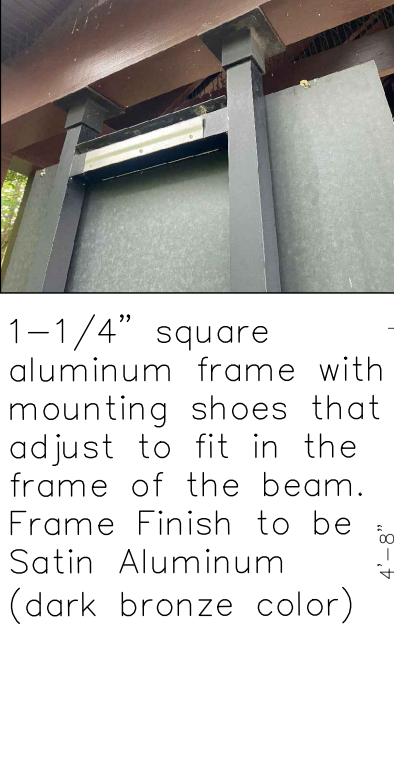
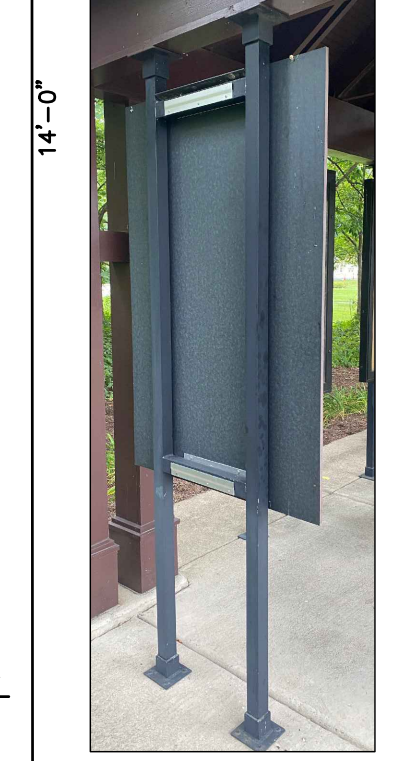

Display Board for Graphics

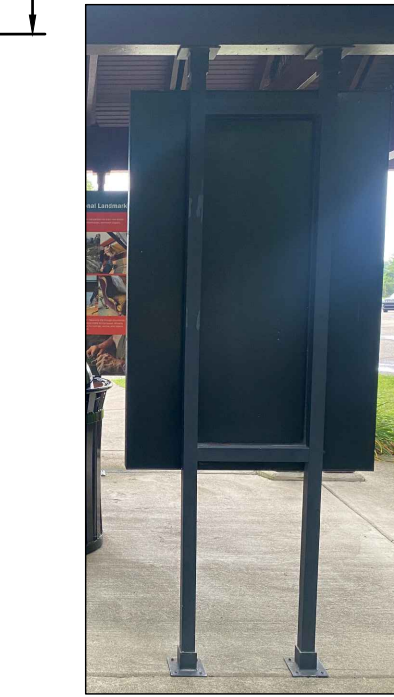

Lockable door with tempered glass break resistant window. Enclosed bulletin board for outdoor usage. Weatherized rear panel with thick rubber door seal. Interior back with tackable vinyl. Exterior case depth is 2"

Precedent Images of Display Board for Graphics

Connect Connector to Concrete

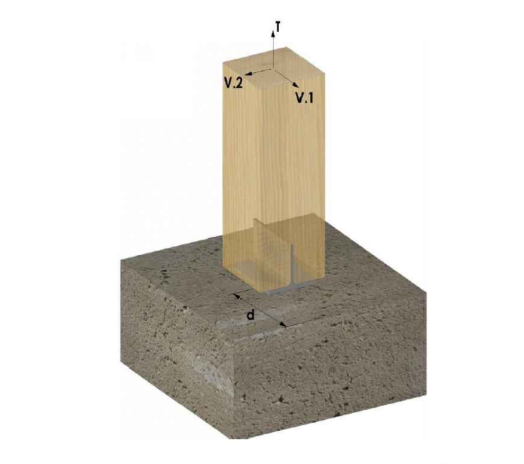

Connection orientation and loading directions

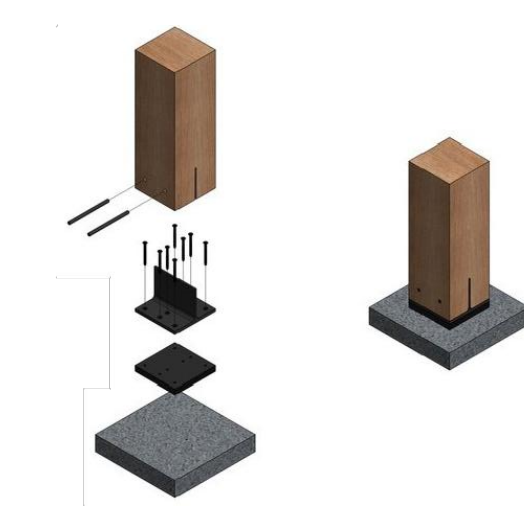

Post Mounting Bracket

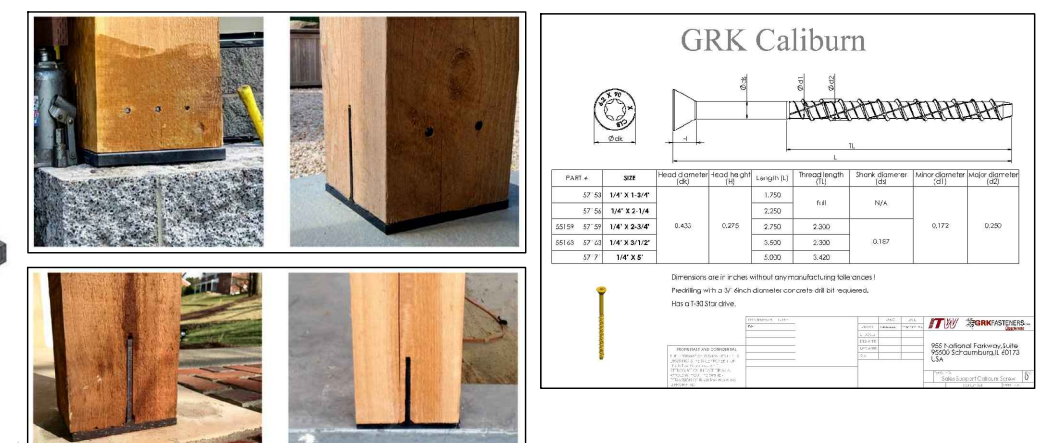
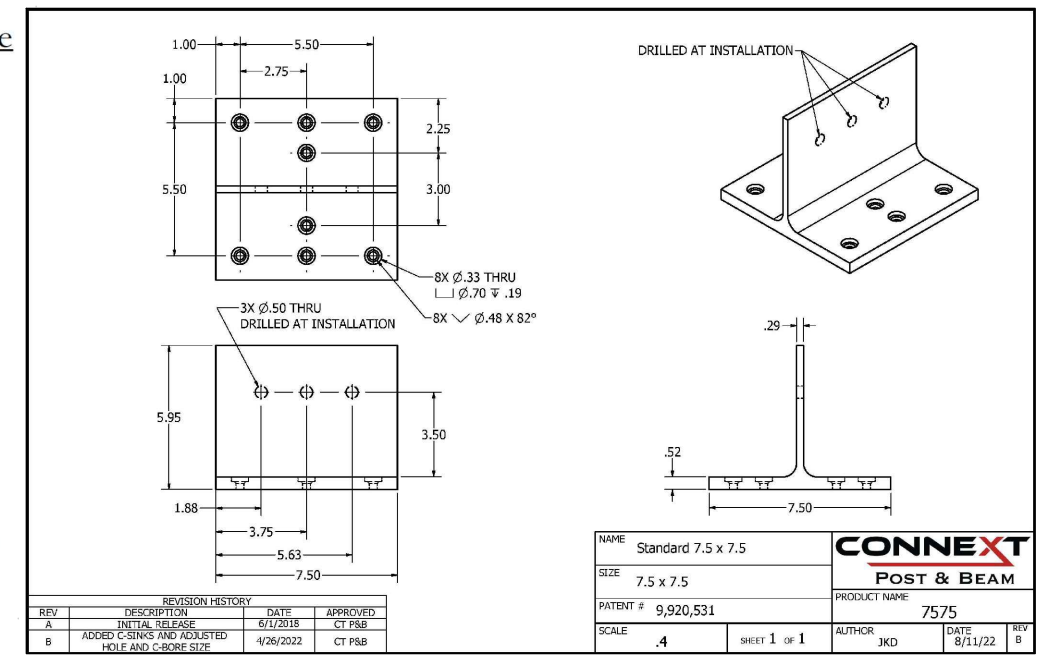

Post Mounting Concrete Screw

Type	Qty	Act. Width	Act. Height	Act. Length	Nom. Width	Nom. Height	Nom. Length	BDFT	Total BDFT	Total LF
Knee Brace	10	3.5	7.5	4'10"	4	8	5	13	133.3	50
Rafter	22	3.5	9.5	10'1"	4	10	12	40	880.0	264
King Post	2	7.5	7.5	4'11"	8	8	6	32	64.0	12
Post	4	7.5	7.5	9'1"	8	8	10	53	213.3	40
Tie Beam	2	7.5	9.5	11'9"	8	10	12	80	160.0	24
Plate	2	7.5	9.5	20'0"	8	10	20	133	266.7	40
Ridge	1	7.5	9.5	20'0"	8	10	20	133	133.3	20
Total BDFT									1850.7	
Total LF									450	

Timber Materials List

Orange County Veterans Memorial

Orange County Southern Human Services Center

Homestead Road
Chapel Hill, NC
October 07, 2023
Rev.

Kiosk Heavy Timber Structure Plan/Elevations

