



TRANSPORTATION AND CONNECTIVITY ADVISORY BOARD

SPECIAL USE PERMIT
4.26.2022

1800 Martin Luther King Jr. Boulevard Special Use Permit

1800 MLK Jr. Blvd., Chapel Hill, NC





SPECIAL USE PERMITS

- Advisory Boards hold a preliminary review forum
- Board members and the public provide comments to applicant
- Comments are not transmitted to Council when part of quasi-judicial review
- Action is not required

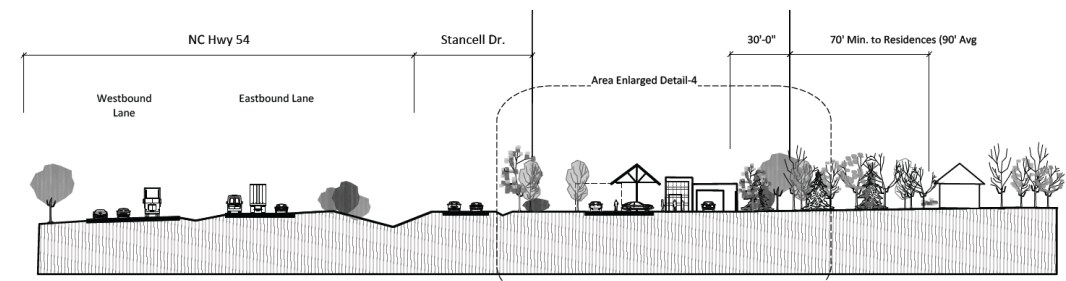
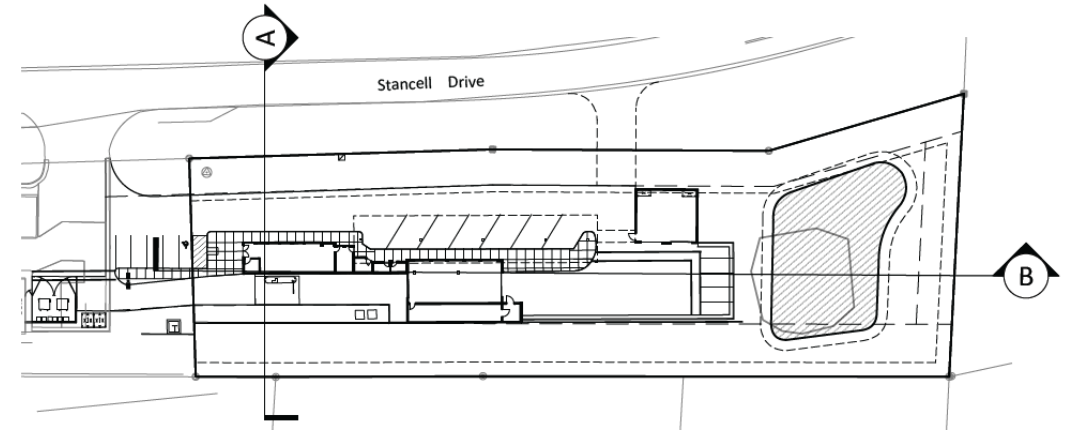



PROCESS OVERVIEW

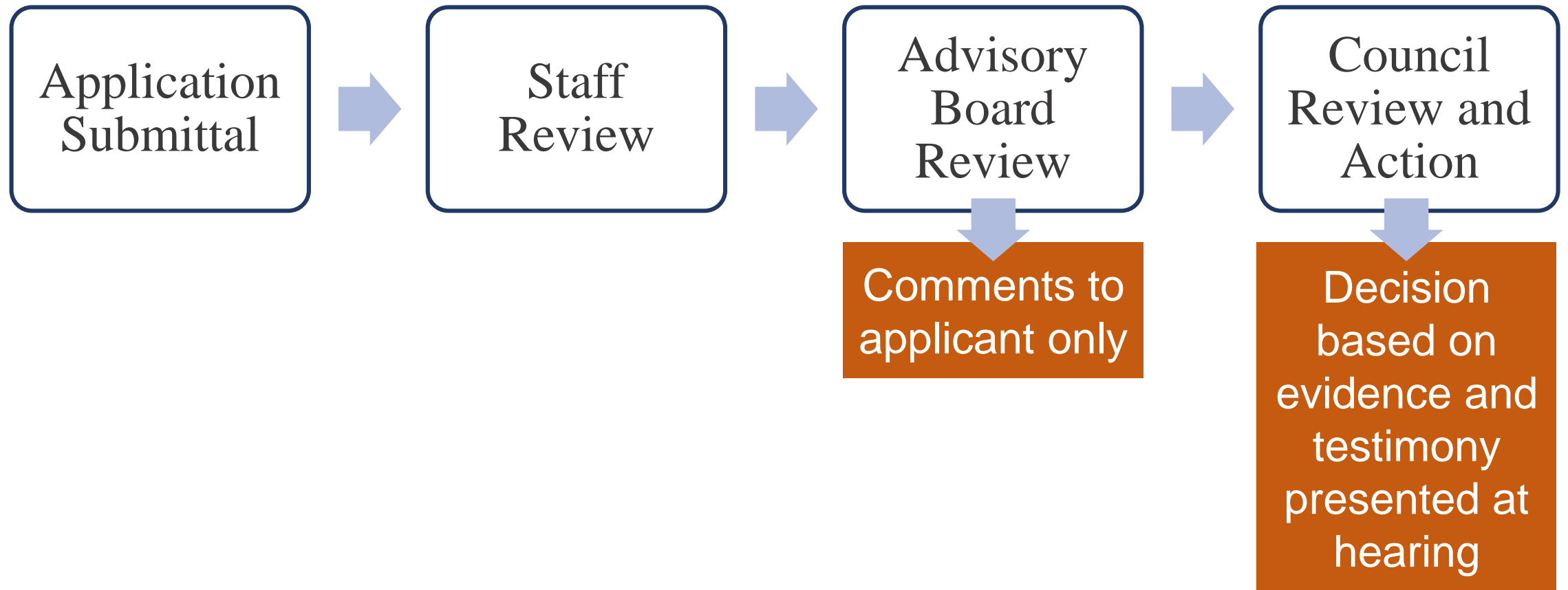



PROJECT SUMMARY

- ❑ Grocery store with proposed gas station and building addition
- ❑ 11,572 sq. ft. addition proposed to existing building
- ❑ Addition of 14 fueling stations and drive-thru lane

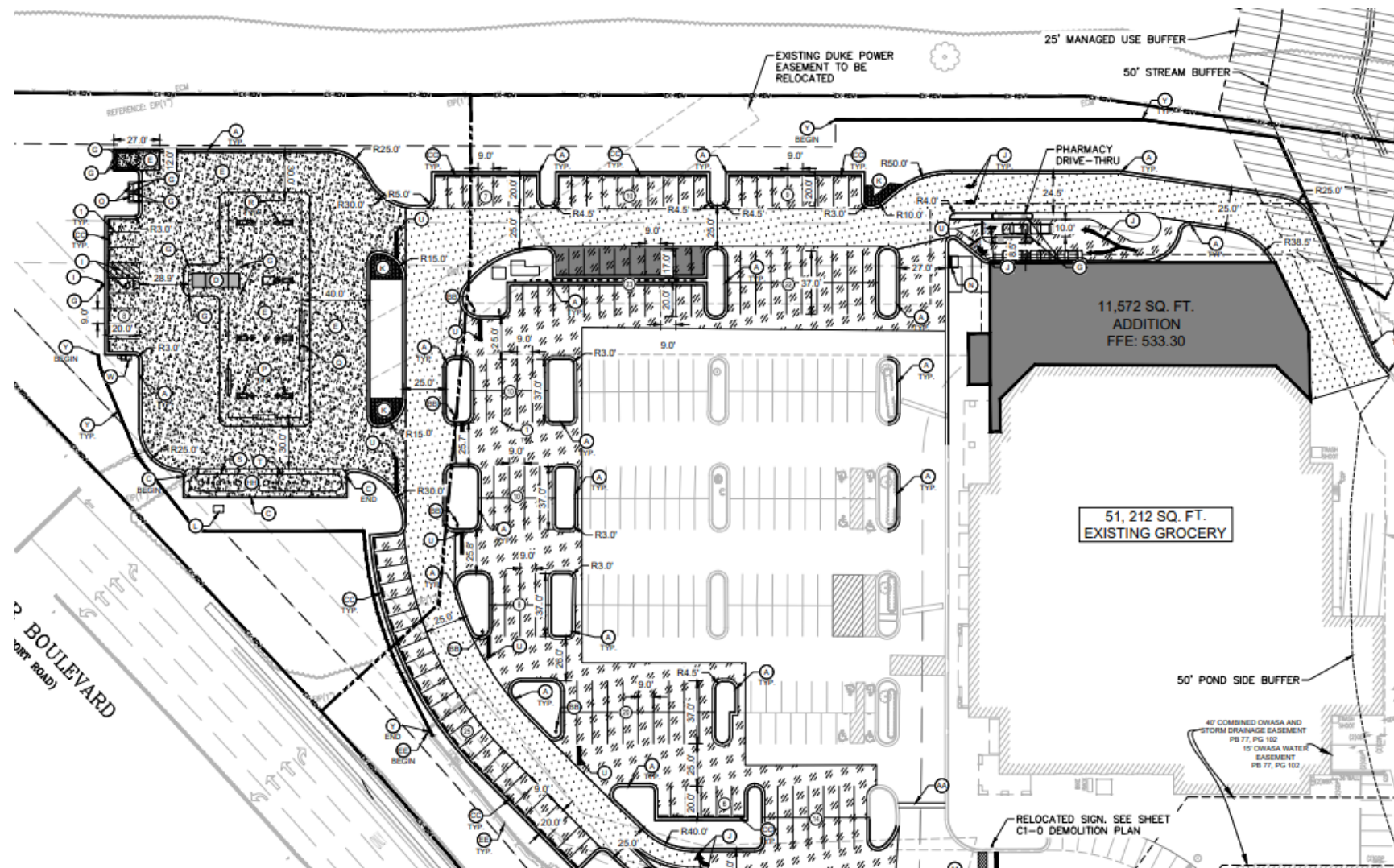



KEY POINTS - *Parking & Access*

- ❑ Proposing 534 parking spaces
 - ❑ 50 vehicle parking spaces added
- ❑ Proposed right-out lane from gas station to access drive near MLK Jr. Boulevard
- ❑ Wider turn radius for driveway on MLK for fuel trucks

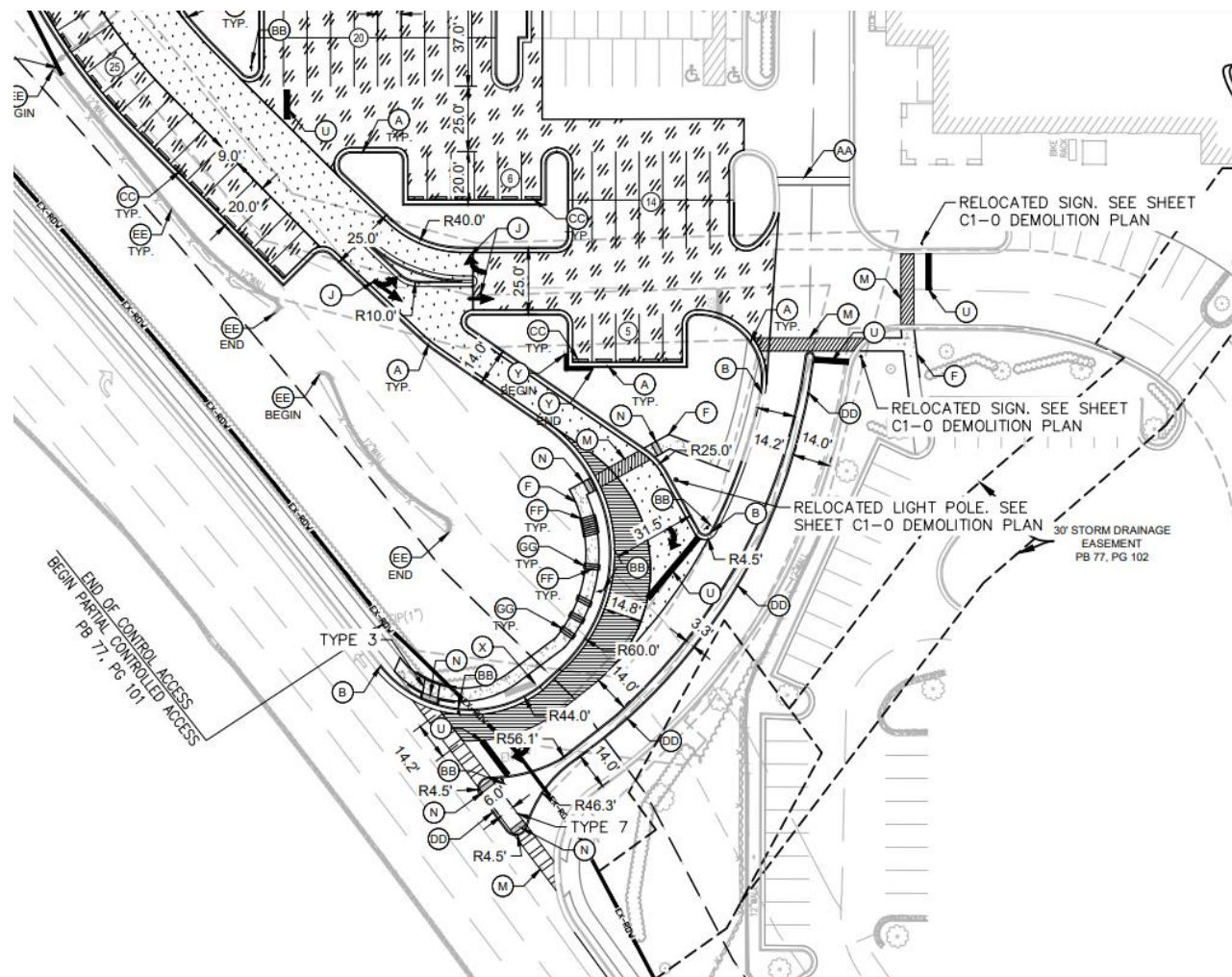



KEY POINTS – *Mobility Plan*

- ❑ Mobility and Connectivity Plan calls for raised bike lane and greenway adjacent to and through property
- ❑ Raised bike lane not proposed for construction
- ❑ Greenway not proposed for construction
 - ❑ Applicant proposes dedicating greenway easement to Town

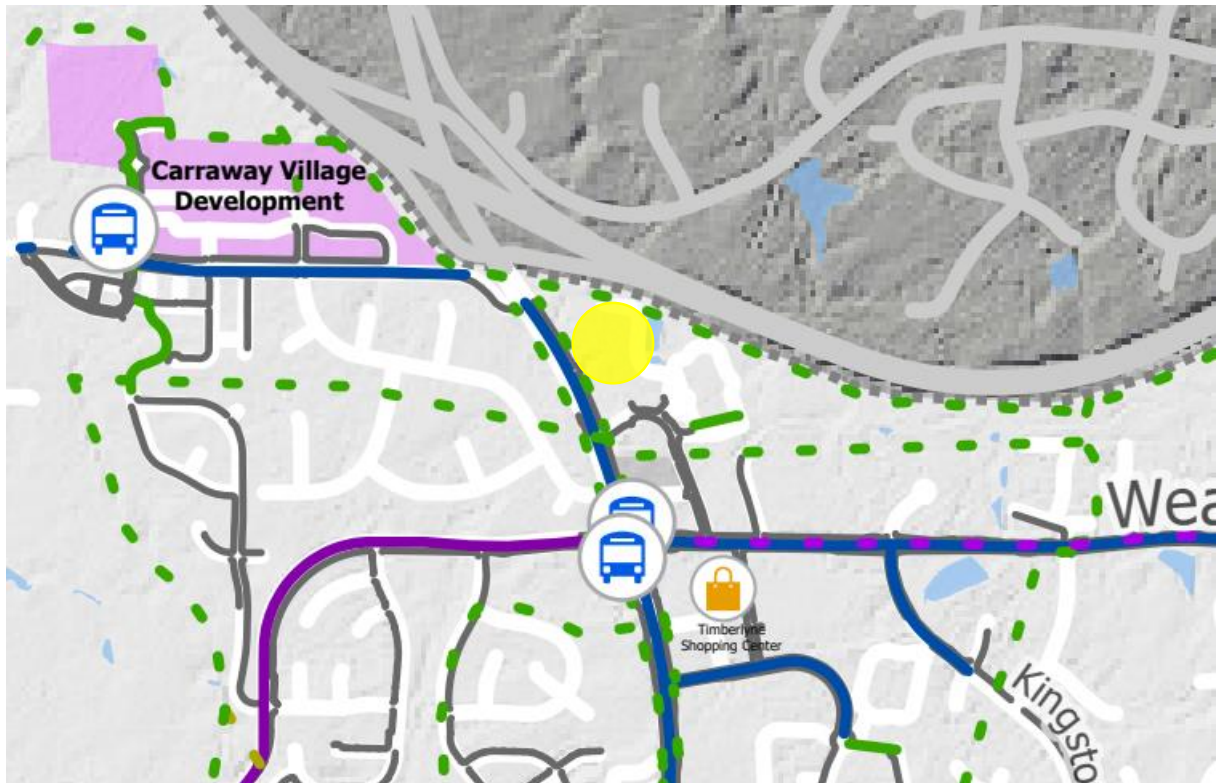



RECOMMENDATION

Provide comments to the applicant



Harris Teeter #223
Chapel Hill, NC
4/1/22

