

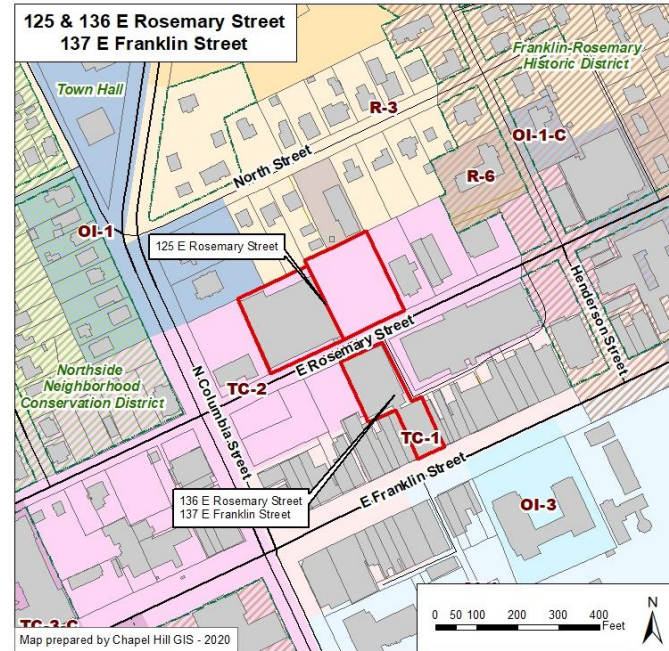

125 E Rosemary St Concept Plan

Community Design Commission
April 2, 2020

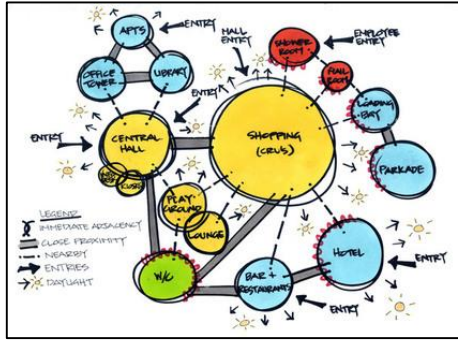



Concept Plans

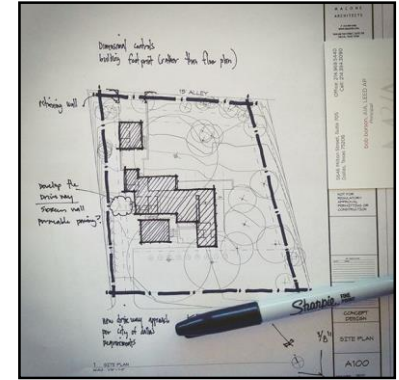

- **No Decision; Feedback Only**
 - Applicant presents rough initial sketch
 - Staff does not conduct formal review of concept
 - Instead forwards sketch for preliminary feedback

Next Step in Process: Submit Formal Development Application

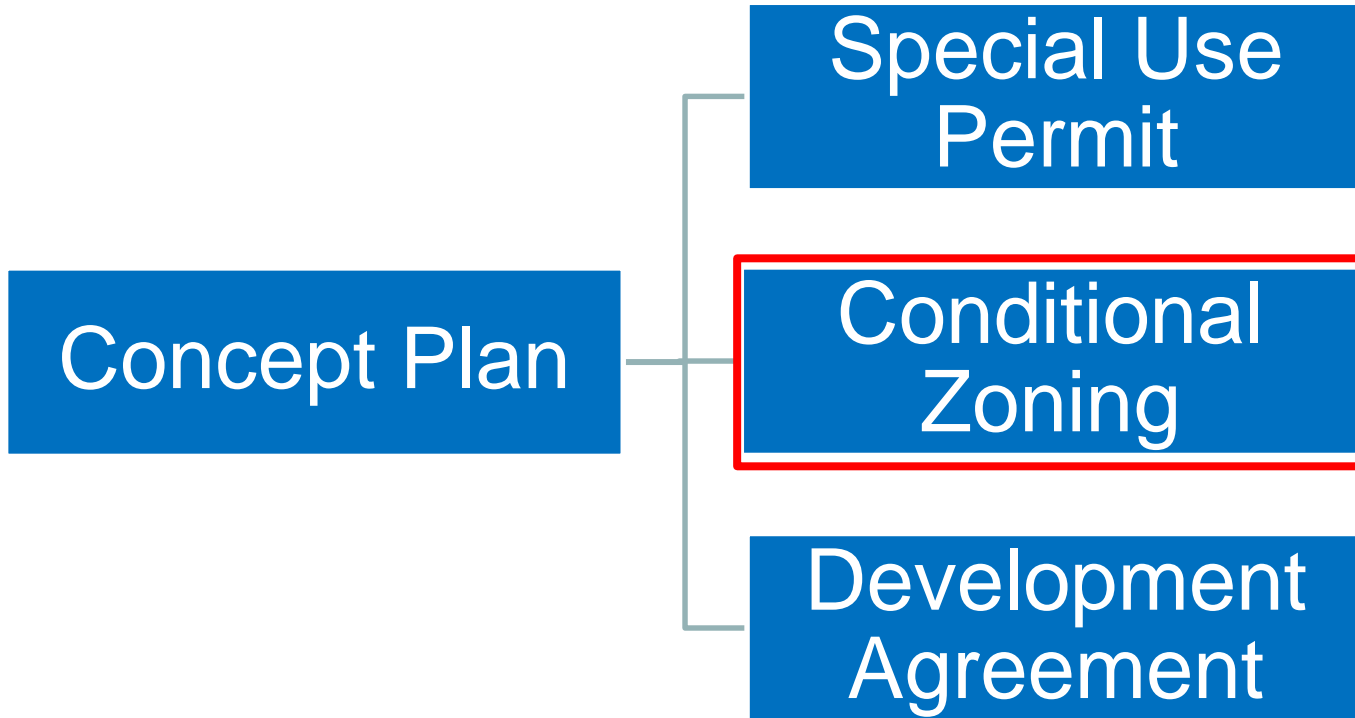

- Adopt Resolution R-#, transmitting comments to the Applicant and Council regarding the proposed development.

125 E Rosemary St – Project Summary

- Existing 276 space parking deck and gravel lot
- Zoning: Town Center – 2
- Proposing a 1,100 space parking deck across both lots
- Project will be coordinated with the 136 E Rosemary Innovation Hub

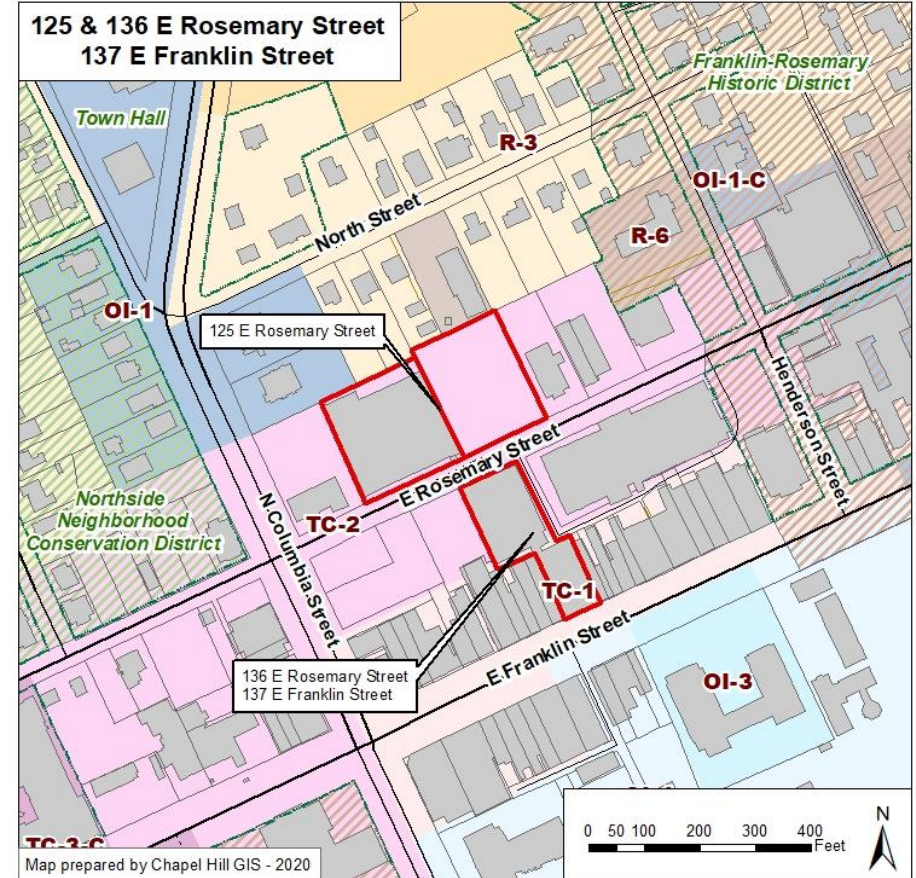

125 E Rosemary St – Existing Conditions

CONTRACTOR SHALL COORDINATE AND HOLD A PRE-DEMOLITION/PRE-CONSTRUCTION CONFERENCE WITH:
• CIVIL ENGINEER AND OWNER'S REPRESENTATIVE
• TOWN OF CHAPEL HILL URBAN FORESTER: (919) 969-5114
• ORANGE COUNTY SOLID WASTE STAFF: (919) 968-2788
• ORANGE COUNTY EROSION CONTROL OFFICER: (919) 245-2587

SIGNS SHALL BE OF AN APPROVED SIZE, WEATHER RESISTANT AND MAINTAINED UNTIL REPLACED BY PERMANENT SIGNS.

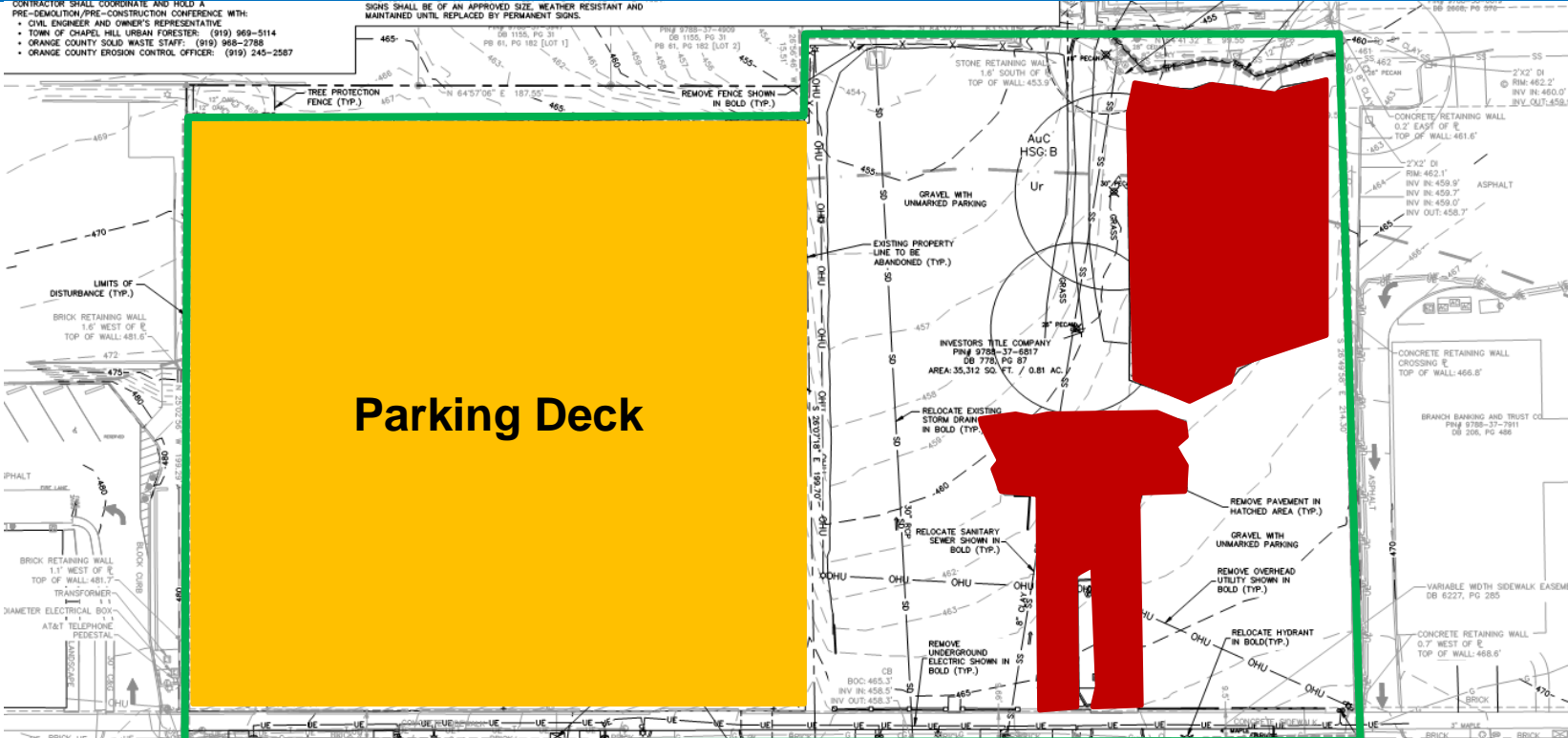

Parking Deck

Rosemary St

125 E Rosemary St – Concept Plan

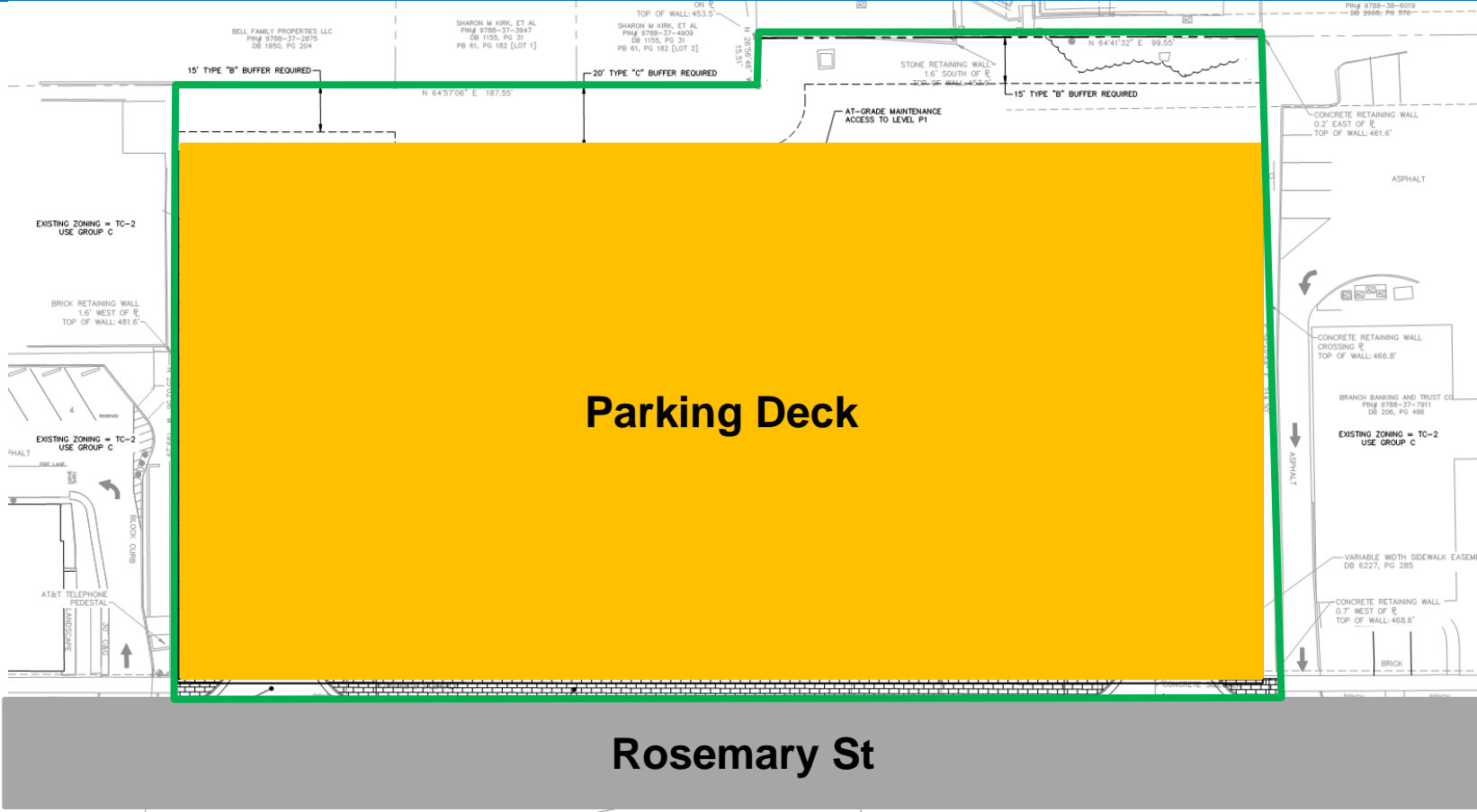

- Adopt Resolution R-#, transmitting comments to the Applicant and Council regarding the proposed development.