



Signature Health Care at 1602 E. Franklin Street Special Use Permit Modification

Town Council
March 24, 2021

DRAFT

Process

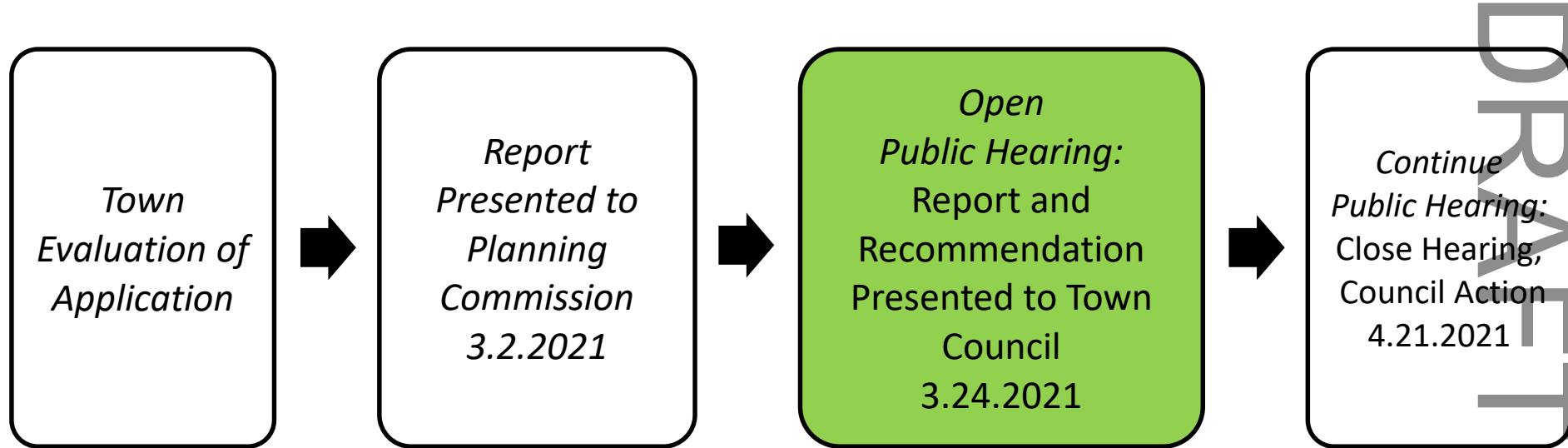

Open the Public Hearing, receive public comment, and continue the public hearing to April 21, 2021.

DRAFT

On January 13, 2021, Council approved a limited scope of review for the Special Use Permit Modification to adjust the construction start and end dates:

From October 25, 2019 and October 25, 2021 to March 24, 2023 to March 24, 2025.

DRAFT

Signature Health Care—Proposed Changes

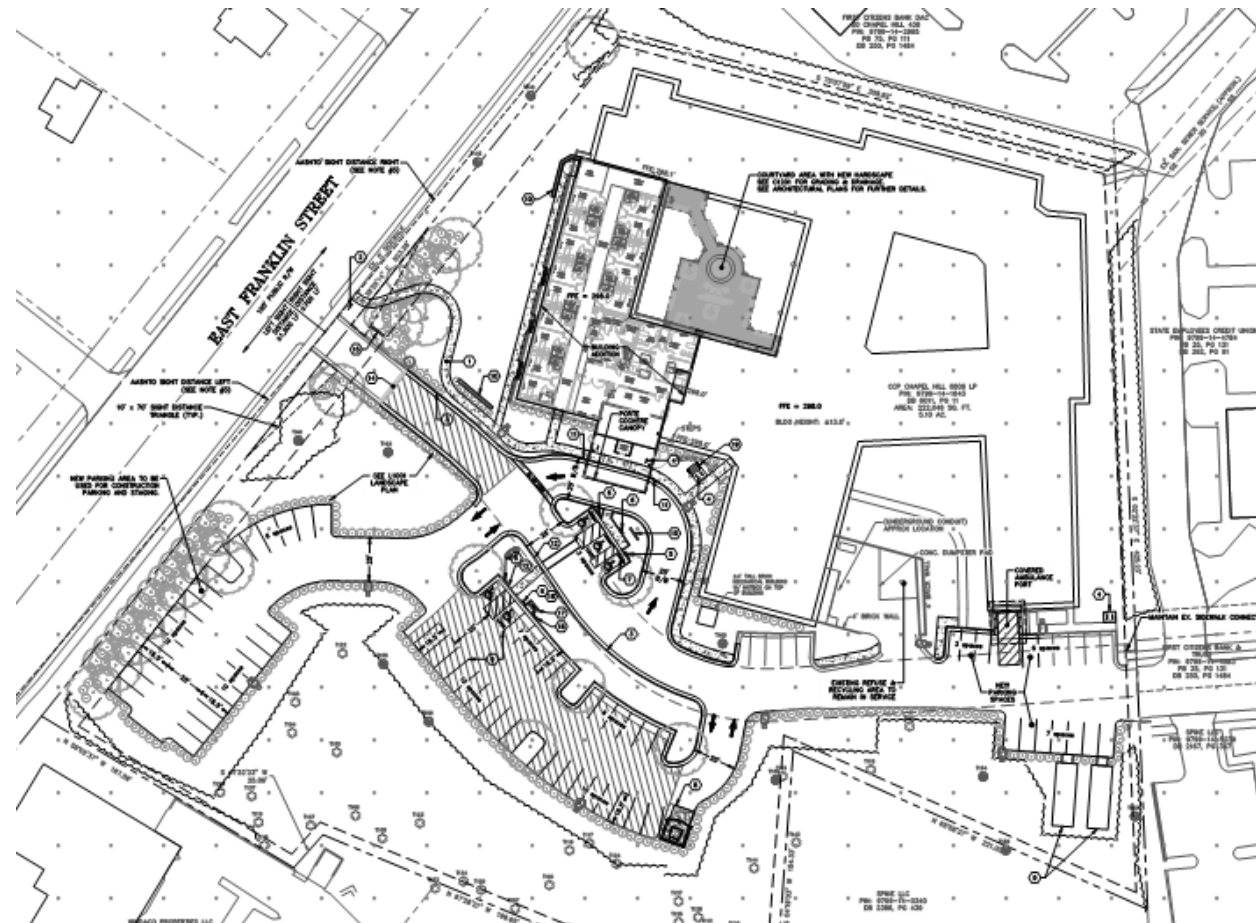

Increase
impervious
surface from
113,336 sq. ft. to
113,533 sq. ft.

(+197 SF)

DRAFT

Open the Public Hearing, receive public comment, and continue the public hearing to April 21, 2021.

DRAFT