



Annexation of 7300 Millhouse Rd



September 14, 2022 | Council Regular Meeting

Where is this in the annexation process?





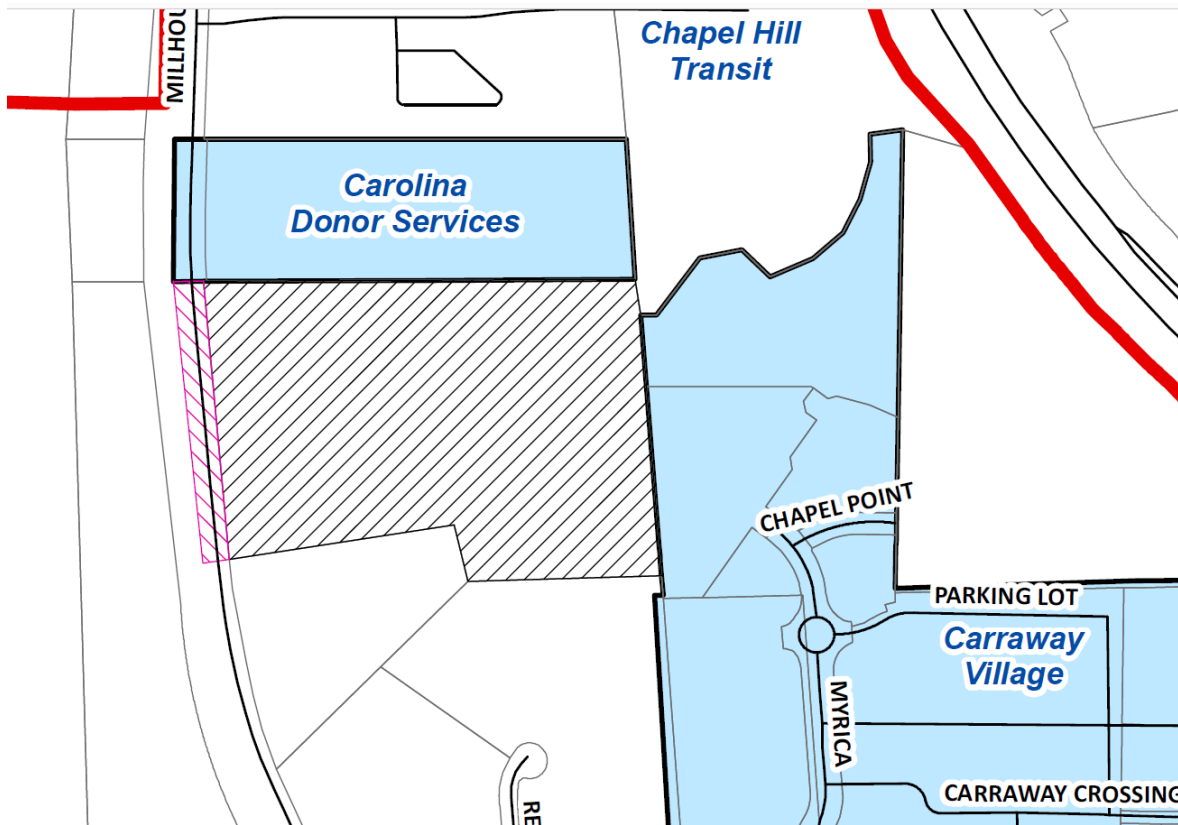

Location



Legend

Type

-  Parcels to be Annexed
-  Right-of-way to be Annexed
-  Chapel Hill Corporate Limits
-  Chapel Hill Planning Jurisdiction

7300 Millhouse Rd
19.65 acres

7300 Millhouse Final Plans

- Final Plans approved May 10, 2022
- 116,690 sq ft flex warehouse space
- Light Industrial Conditional Zoning

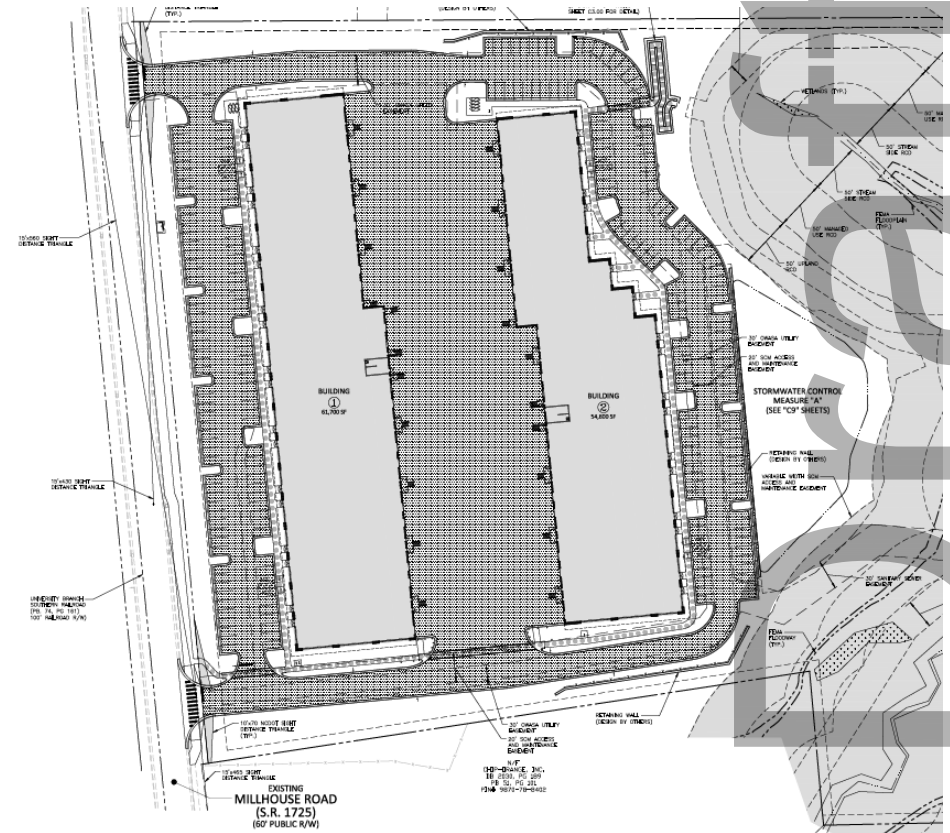

Fiscal Analysis

- **Annual Governmental Revenue:**
\$125,895 estimated
- **Annual Governmental Costs:**
\$101,375 estimated
- **Net Annual Financial Impact:** +\$24,520
- **Fire District Payment:** \$674.65, one-time,
to offset long-term debt

Draft





Recommendation

- Enact an Ordinance to annex the property at 7300 Millhouse Rd (O-#)

Annexation effective at midnight

Legend

Type

-  Parcels to be Annexed
-  Right-of-way to be Annexed
-  Chapel Hill Corporate Limits
-  Chapel Hill Planning Jurisdiction

