

PLANTING SCHEDULE

SYMBOL	QTY	BOTANICAL & COMMON PLANT NAME	SIZE	COMMENTS
CANOPY TREES				
AR	29	Acer rubrum 'October Brilliance' (October Brilliance)	2" to 2-1/2" Cal. Min.	**
FG	29	Fagus grandiflora (American Beech)	2" to 2-1/2" Cal. Min.	**
IO	26	Ilex opaca (American Holly)	2" to 2-1/2" Cal. Min.	**
LT	39	Liriodendron tulipifera (Tulip Poplar)	2" to 2-1/2" Cal. Min.	**
NS	48	Nyssa sylvatica (Black Gum)	2" to 2-1/2" Cal. Min.	**
QP	32	Quercus phellos (Willow Oak)	2" to 2-1/2" Cal. Min.	**
QUP	33	Quercus pagodifolia (Cherrybark Oak)	4" to 4-1/2" Cal. Min.	**
QV	24	Quercus virginiana (Live Oak)	2" to 2-1/2" Cal. Min.	**
TC	38	Tilia cordata (Little Leaf Linden)	2" to 2-1/2" Cal. Min.	**
DECIDUOUS UNDERSTORY TREES				
AA	69	Amelanchier arborea (Serviceberry)	2-2.5" cal. min	**
CC	21	Cercis canadensis 'Forest Pansy' (Forest Pansy Redbud)	2-2.5" cal. min	**
CV	18	Chionanthus virginicus (Fringe Tree)	2-2.5" cal. min	**
SR	62	Carpinus caroliniana (American Hornbeam)	2-2.5" cal. min	**
OS	18	Osmanthus americanus (Devilwood)	2-2.5" cal. min	**
OV	13	Crataegus viridis "Winter King" (Winter King Hawthorn)	2-2.5" cal. min	**

SYMBOL	QTY	BOTANICAL & COMMON PLANT NAME	SIZE	COMMENTS
BUFFER SHRUBS				
BS	206	Buxus sempervirens 'Liberty' (Common Boxwood)	36" Ht. Min.	
CH	182	Cephalotaxus harringtonia 'Fastigiata' (Upright Plum Yew)	36" Ht. Min.	
CJ	191	Camellia japonica (Japanese Camellia)	36" Ht. Min.	
CS	155	Camellia sasanqua (Sasanqua Camellia)	36" Ht. Min.	
EJ	48	Euonymus japonicus (Japanese Euonymus)	36" Ht. Min.	
GJ	51	Gardenia jasminoides (Cape Jasmine Gardenia)	36" Ht. Min.	
IC	53	Ilex crenata 'Soft Touch' (Soft Touch Holly)	36" Ht. Min.	
ICC	40	Ilex crenata 'Chesapeake' (Japanese Holly)	36" Ht. Min.	
JP	194	Juniperus x pfitzeriana 'Sea Green' (Sea Green Juniper)	36" Ht. Min.	
LD	11	Loropetalum daruma (Chinese Fringe Flower)	36" Ht. Min.	
PLANTED ISLAND SHRUBS				
IG	59	Ilex x glabra 'Compacta' (Inkberry Holly)	18" to 24" Ht. Min.	
IV	87	Itea virginica (Virginia Sweet Spire)	18" to 24" Ht. Min.	
JC	77	Juniperus chinensis 'Sargentii' (Sargent's Juniper)	18" to 24" Ht. Min.	
JS	164	Juniperus squamata (Star Juniper)	18" to 24" Ht. Min.	
LC	126	Loropetalum chinensis 'Purple Pixie' (Purple Pixie Fringe Flower)	18" to 24" Ht. Min.	
LF	46	Leucothoe fontanesiana (Drooping Leucothoe)	18" to 24" Ht. Min.	
RK	77	Rosa x 'Red Knock Out' (Red Knock Out Rose)	18" to 24" Ht. Min.	
SS	259	Schizachyrium scoparium (Little Bluestem)	18" to 24" Ht. Min.	

MINIMUM SPACING (FT)			
	LARGE TREE	SMALL TREE	SHRUBS
LARGE TREE	10'	8'	3'
SMALL TREE	8'	8'	3'
SHRUBS	3'	3'	4'

LANDSCAPE ISLAND PLANTING SCHEMES

*USE PLANT QUANTITIES AS APPLICABLE FOR HALF ISLANDS (TYP).

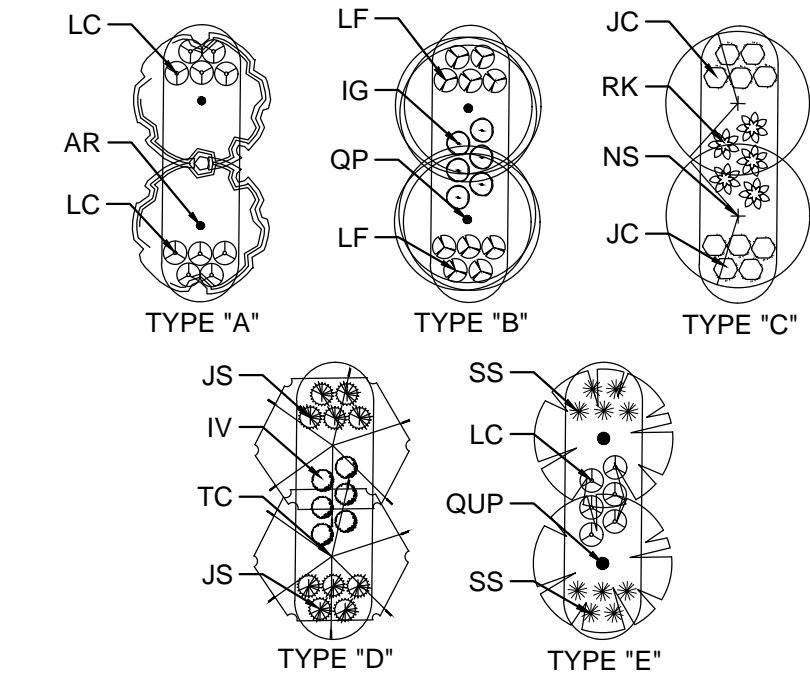

* IRRIGATION TO BE PROVIDED FOR THESE TREES TO REACH MAXIMUM MATURITY.
** REFERS TO APPROVED SUP OCTOBER 23, 2018

ADDITIONAL APPROVED TREES:
LAGERSTROEMIA x 'NATCHEZ'
QUERCUS RUBRA
ZELKOVA SERRATA
GINKGO BILOBA (male)
FAGUS SYLVATICA 'RIVERSII'
SYRINGA RETICULATA
OSTRYA VIRGINIA

LEGEND

■ DENOTES TREE SHADE COVERAGE

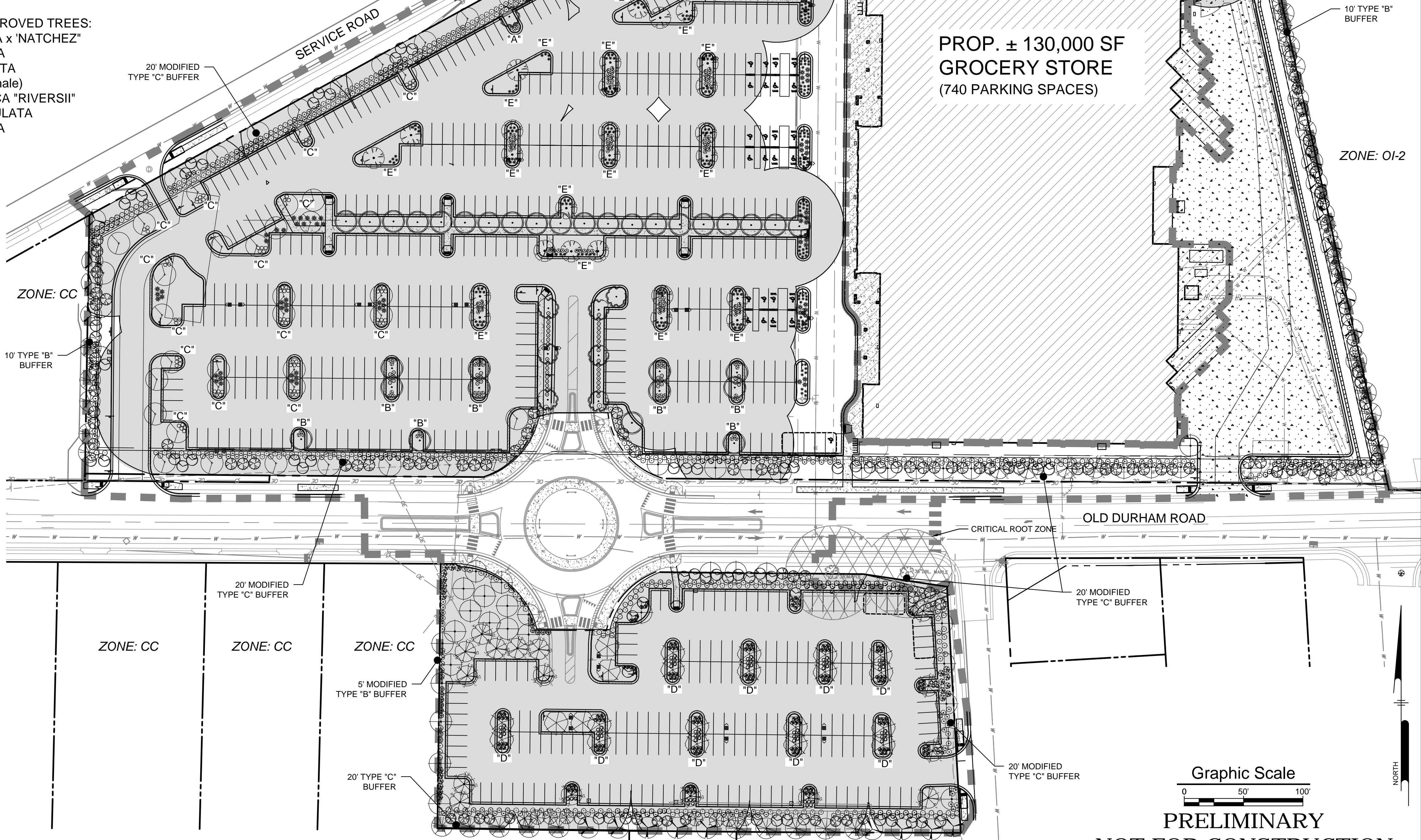

Pennoni
Firm License
F-1287
PENNONI ASSOCIATES INC.
401 Providence Road #200
Chapel Hill, NC 27514
T 919.929.1173 F 919.493.6548

ALL DIMENSIONS MUST BE VERIFIED BY CONTRACTOR AND OWNER MUST BE NOTIFIED OF ANY DISCREPANCIES BEFORE PROCEEDING WITH WORK

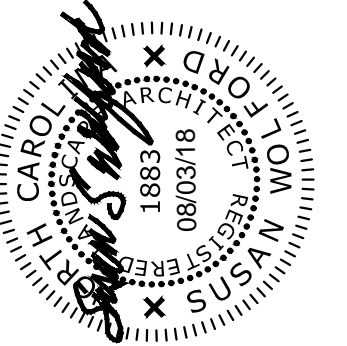

PROPOSED GROCERY STORE

1810 FORDHAM BLVD
CHAPEL HILL, NC 27514

LANDSCAPE PLAN

LEON CAPITAL GROUP
5870 FAIRVIEW ROAD, SUITE 450
CHARLOTTE, NC 28210

NO.	DATE	REVISIONS	BY
1	1/07/2018	PER MODIFIED BUILDING FOOTPRINT	SAK
2	8/05/2018	PER MODIFIED BUILDING FOOTPRINT	SAK
3	7/30/2018	PER TOWN COMMENTS	SAK
4	8/07/2018	PER TOWN COMMENTS	SAK
5	5/30/2018	PER TOWN COMMENTS	SAK
6	5/03/2018	FINAL ECP APPROVAL	SAK
7	5/03/2018	PER TOWN COMMENTS	SAK
8	5/03/2018	PER TOWN COMMENTS	SAK
9	5/03/2018	PER TOWN COMMENTS	SAK
10	5/03/2018	PER TOWN COMMENTS	SAK
11	5/03/2018	PER TOWN COMMENTS	SAK
12	5/03/2018	PER TOWN COMMENTS	SAK
13	5/03/2018	PER TOWN COMMENTS	SAK
14	5/03/2018	PER TOWN COMMENTS	SAK
15	5/03/2018	PER TOWN COMMENTS	SAK
16	5/03/2018	PER TOWN COMMENTS	SAK
17	5/03/2018	PER TOWN COMMENTS	SAK
18	5/03/2018	PER TOWN COMMENTS	SAK
19	5/03/2018	PER TOWN COMMENTS	SAK
20	5/03/2018	PER TOWN COMMENTS	SAK
21	5/03/2018	PER TOWN COMMENTS	SAK
22	5/03/2018	PER TOWN COMMENTS	SAK
23	5/03/2018	PER TOWN COMMENTS	SAK
24	5/03/2018	PER TOWN COMMENTS	SAK
25	5/03/2018	PER TOWN COMMENTS	SAK
26	5/03/2018	PER TOWN COMMENTS	SAK
27	5/03/2018	PER TOWN COMMENTS	SAK
28	5/03/2018	PER TOWN COMMENTS	SAK
29	5/03/2018	PER TOWN COMMENTS	SAK
30	5/03/2018	PER TOWN COMMENTS	SAK
31	5/03/2018	PER TOWN COMMENTS	SAK
32	5/03/2018	PER TOWN COMMENTS	SAK
33	5/03/2018	PER TOWN COMMENTS	SAK
34	5/03/2018	PER TOWN COMMENTS	SAK
35	5/03/2018	PER TOWN COMMENTS	SAK
36	5/03/2018	PER TOWN COMMENTS	SAK
37	5/03/2018	PER TOWN COMMENTS	SAK
38	5/03/2018	PER TOWN COMMENTS	SAK
39	5/03/2018	PER TOWN COMMENTS	SAK
40	5/03/2018	PER TOWN COMMENTS	SAK
41	5/03/2018	PER TOWN COMMENTS	SAK
42	5/03/2018	PER TOWN COMMENTS	SAK
43	5/03/2018	PER TOWN COMMENTS	SAK
44	5/03/2018	PER TOWN COMMENTS	SAK
45	5/03/2018	PER TOWN COMMENTS	SAK
46	5/03/2018	PER TOWN COMMENTS	SAK
47	5/03/2018	PER TOWN COMMENTS	SAK
48	5/03/2018	PER TOWN COMMENTS	SAK
49	5/03/2018	PER TOWN COMMENTS	SAK
50	5/03/2018	PER TOWN COMMENTS	SAK
51	5/03/2018	PER TOWN COMMENTS	SAK
52	5/03/2018	PER TOWN COMMENTS	SAK
53	5/03/2018	PER TOWN COMMENTS	SAK
54	5/03/2018	PER TOWN COMMENTS	SAK
55	5/03/2018	PER TOWN COMMENTS	SAK
56	5/03/2018	PER TOWN COMMENTS	SAK
57	5/03/2018	PER TOWN COMMENTS	SAK
58	5/03/2018	PER TOWN COMMENTS	SAK
59	5/03/2018	PER TOWN COMMENTS	SAK
60	5/03/2018	PER TOWN COMMENTS	SAK
61	5/03/2018	PER TOWN COMMENTS	SAK
62	5/03/2018	PER TOWN COMMENTS	SAK
63	5/03/2018	PER TOWN COMMENTS	SAK
64	5/03/2018	PER TOWN COMMENTS	SAK
65	5/03/2018	PER TOWN COMMENTS	SAK
66	5/03/2018	PER TOWN COMMENTS	SAK
67	5/03/2018	PER TOWN COMMENTS	SAK
68	5/03/2018	PER TOWN COMMENTS	SAK
69	5/03/2018	PER TOWN COMMENTS	SAK
70	5/03/2018	PER TOWN COMMENTS	SAK
71	5/03/2018	PER TOWN COMMENTS	SAK
72	5/03/2018	PER TOWN COMMENTS	SAK
73	5/03/2018	PER TOWN COMMENTS	SAK
74	5/03/2018	PER TOWN COMMENTS	SAK
75	5/03/2018	PER TOWN COMMENTS	SAK
76	5/03/2018	PER TOWN COMMENTS	SAK
77	5/03/2018	PER TOWN COMMENTS	SAK
78	5/03/2018	PER TOWN COMMENTS	SAK
79	5/03/2018	PER TOWN COMMENTS	SAK
80	5/03/2018	PER TOWN COMMENTS	SAK
81	5/03/2018	PER TOWN COMMENTS	SAK
82	5/03/2018	PER TOWN COMMENTS	SAK
83	5/03/2018	PER TOWN COMMENTS	SAK
84	5/03/2018	PER TOWN COMMENTS	SAK
85	5/03/2018	PER TOWN COMMENTS	SAK
86	5/03/2018	PER TOWN COMMENTS	SAK
87	5/03/2018	PER TOWN COMMENTS	SAK
88	5/03/2018	PER TOWN COMMENTS	SAK
89	5/03/2018	PER TOWN COMMENTS	SAK
90	5/03/2018	PER TOWN COMMENTS	SAK
91	5/03/2018	PER TOWN COMMENTS	SAK
92	5/03/2018	PER TOWN COMMENTS	SAK
93	5/03/2018	PER TOWN COMMENTS	SAK
94	5/03/2018	PER TOWN COMMENTS	SAK
95	5/03/2018	PER TOWN COMMENTS	SAK
96	5/03/2018	PER TOWN COMMENTS	SAK
97	5/03/2018	PER TOWN COMMENTS	SAK
98	5/03/2018	PER TOWN COMMENTS	SAK
99	5/03/2018	PER TOWN COMMENTS	SAK
100	5/03/2018	PER TOWN COMMENTS	SAK

ALL DOCUMENTS PREPARED BY PENNONI ASSOCIATES ARE INSTRUMENTS OF SERVICE IN RESPECT OF THE PROJECT. THEY ARE NOT INTENDED OR REPRESENTED TO BE SUITABLE FOR REUSE BY OWNER OR OTHERS ON THE EXTENSIONS OF THE PROJECT OR ON ANY OTHER PROJECT. ANY REUSE WITHOUT WRITTEN VERIFICATION OR ADAPTATION BY PENNONI ASSOCIATES FOR THE SPECIFIC PURPOSE INTENDED WILL BE AT OWNERS SOLE RISK AND WITHOUT LIABILITY OR LEGAL EXPOSURE TO PENNONI ASSOCIATES AND OWNER SHALL INDEMNIFY AND HOLD HARMLESS PENNONI ASSOCIATES FROM ALL CLAIMS, DAMAGES, LOSSES AND EXPENSES ARISING OUT OF OR RESULTING THEREFROM.

PROJECT	LCGR1601
DATE	2017-12-01
DRAWING SCALE	1" = 50'
DRAWN BY	TJM
APPROVED BY	SLS
SHEET	10 OF 30

PRELIMINARY
NOT FOR CONSTRUCTION