

# CARRAWAY RESIDENTIAL PHASE III

## Concept Plan



Chapel Hill Town Council  
23 October 2024





Area Map  
Carraway Residential Phase III





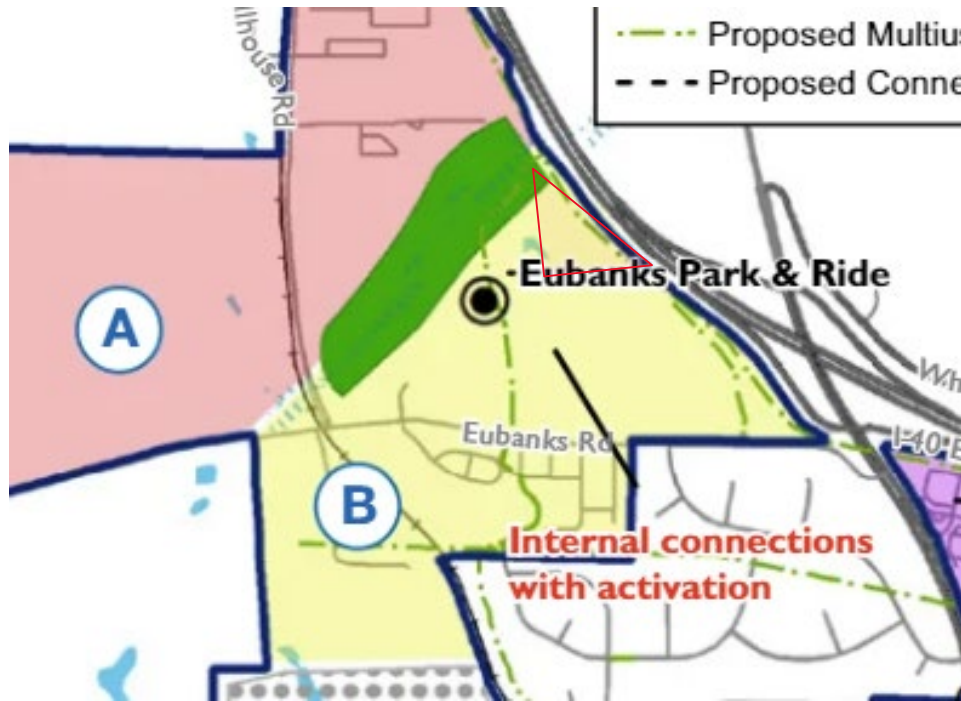

LOCATED IN THE NORTH  
MLK FOCUS AREA

FLUM SUPPORTS:

- MULTI-FAMILY
- TOWNHOME
- RESIDENCES

	Sub-Area B
Multifamily, Shops & Offices	●
Multifamily Residential	●
Commercial/Office	○
Parks and Green/Gathering Spaces	●
Townhouses & Residences	○
Institutional/University/Civic	●
Light Industrial	○
Typical Height	6 stories
Transitional Area Height	Up to 4 stories
Activated Street Frontage Height	N/A

FLUM

Carraway Residential Phase III



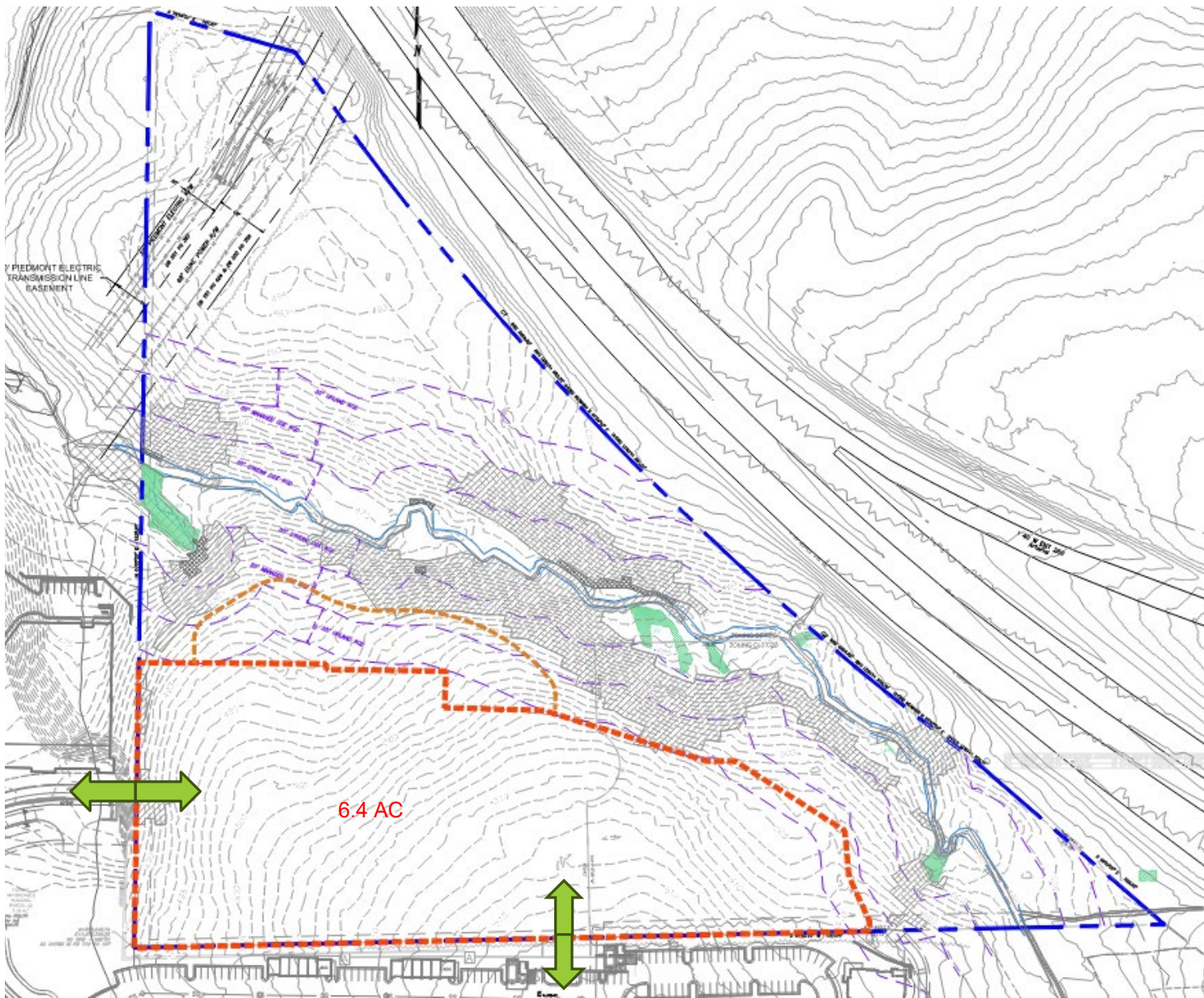

Development will be concentrated in the area south of the stream.

Development will avoid steep slopes and wetlands.

Proposed development in the RCD zones will be for stormwater mitigation and greenway trail only.

I-40 landscape buffer to remain treed.

Two points of access.

## Existing Conditions Carraway Residential Phase III





Concept Plan  
 Carraway Residential Phase III







Carraway Village Site  
Carraway Residential Phase III







Existing Carraway Village Residential  
– Phases I and II

Carraway Residential Phase III







Concept Plan  
Carraway Residential Phase III







Vision for Phase III – New Product Types

Carraway Residential Phase III

