

PRELIMINARY EASEMENT EXHIBIT



Bk: RB1077/512 7 of 7

EXHIBIT "B"

BOOK 1077 PAGE 512

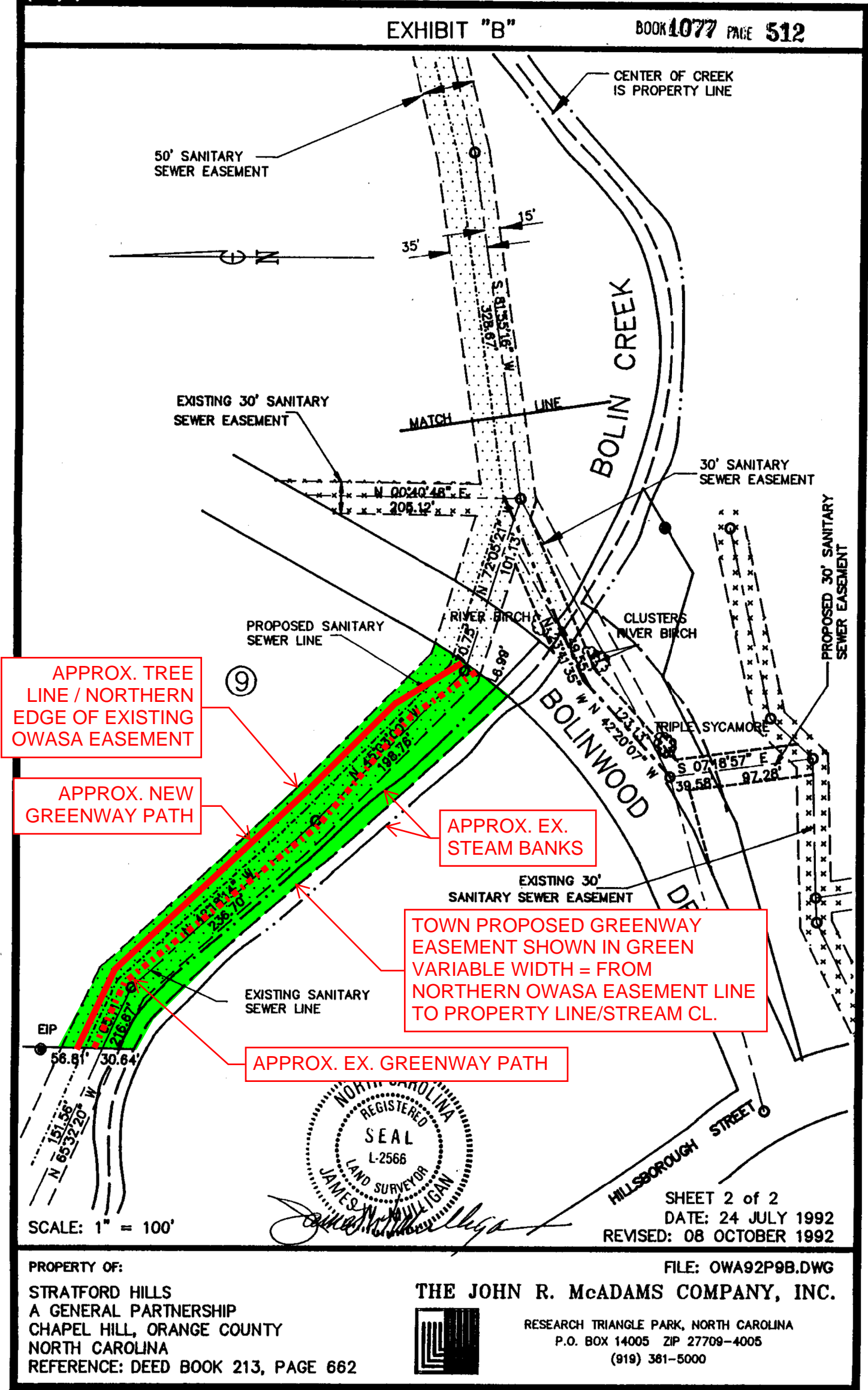

APPROX. TREE LINE / NORTHERN EDGE OF EXISTING OWASA EASEMENT

APPROX. NEW GREENWAY PATH

APPROX. EX. STEAM BANKS

TOWN PROPOSED GREENWAY EASEMENT SHOWN IN GREEN VARIABLE WIDTH = FROM NORTHERN OWASA EASEMENT LINE TO PROPERTY LINE/STREAM CL.

APPROX. EX. GREENWAY PATH



James W. Mulligan

SHEET 2 of 2
DATE: 24 JULY 1992
REVISED: 08 OCTOBER 1992

PROPERTY OF:
STRATFORD HILLS
A GENERAL PARTNERSHIP
CHAPEL HILL, ORANGE COUNTY
NORTH CAROLINA
REFERENCE: DEED BOOK 213, PAGE 662



THE JOHN R. McADAMS COMPANY, INC.
RESEARCH TRIANGLE PARK, NORTH CAROLINA
P.O. BOX 14005 ZIP 27709-4005
(919) 381-5000

FILE: OWA92P9B.DWG