

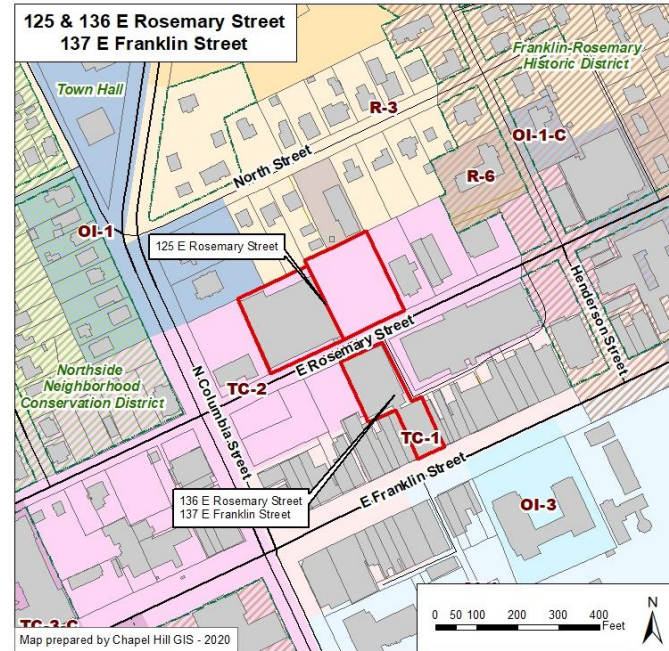

# 125 E Rosemary St Concept Plan

Town Council  
April 22, 2020

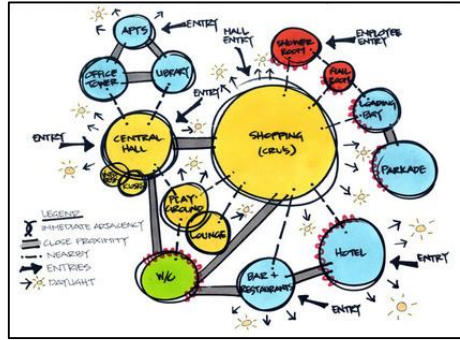



## Concept Plans

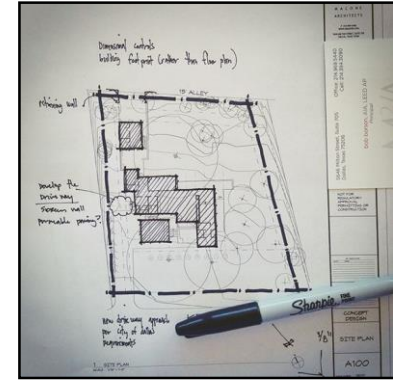

- **No Decision; Feedback Only**
  - Applicant presents rough initial sketch
  - Staff does not conduct formal review of concept
  - Instead forwards sketch for preliminary feedback

# Next Step in Process: Submit Formal Development Application

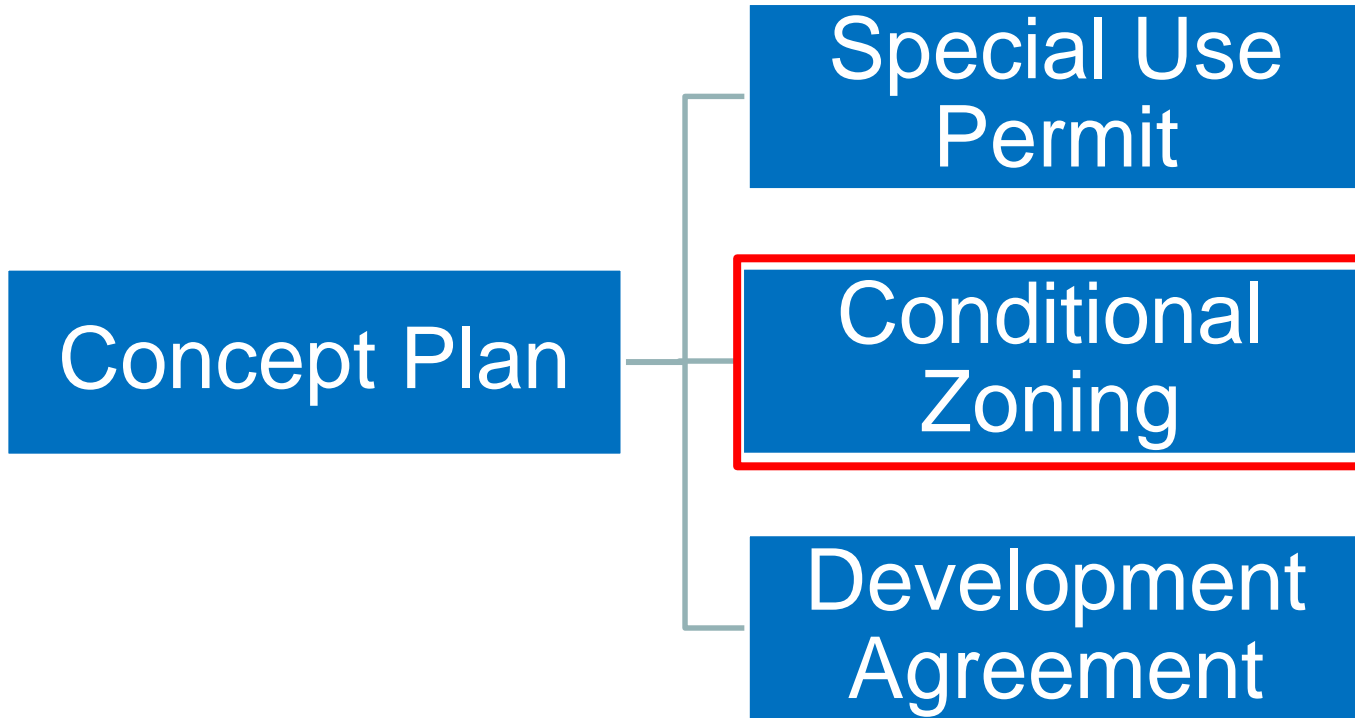

- Adopt Resolution R-8, transmitting comments to the Applicant regarding the proposed development.

# 125 E Rosemary St – Project Summary

- Existing 276 space parking deck and gravel lot
- Zoning: Town Center–2-Conditional Zoning
- Proposing up to 1,160 space parking deck across both lots
- Project will be coordinated with the 136 E. Rosemary Innovation Hub

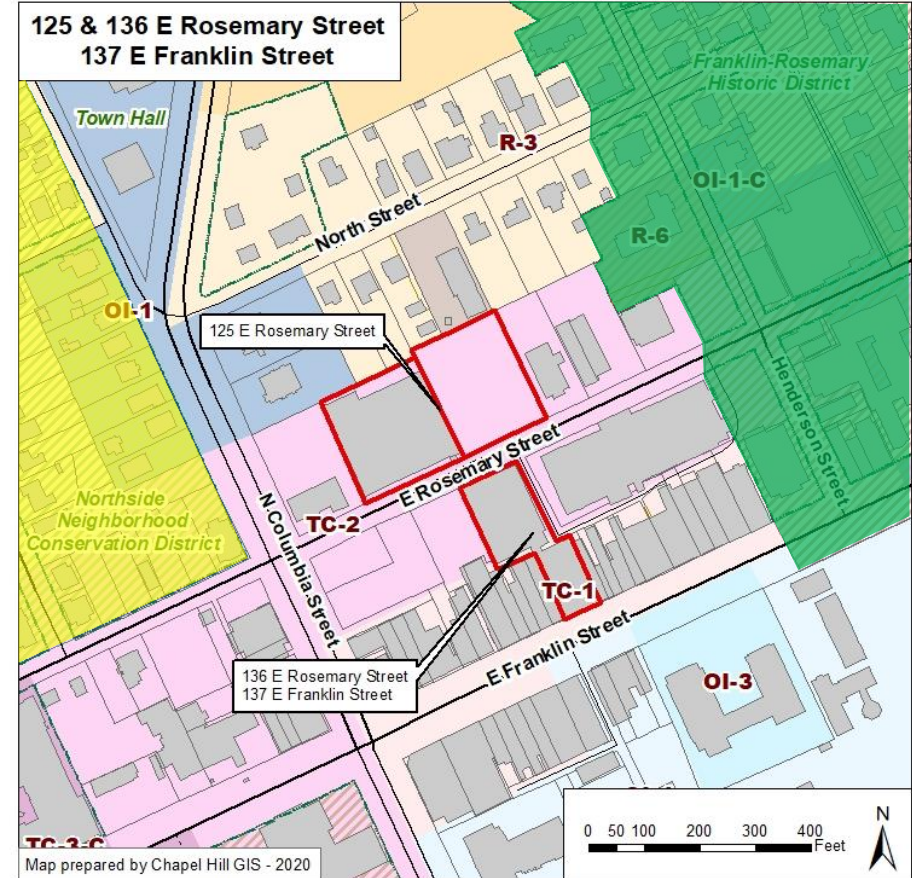

# 125 E Rosemary St – Existing Conditions

CONTRACTOR SHALL COORDINATE AND HOLD A PRE-DEMOLITION/PRE-CONSTRUCTION CONFERENCE WITH:  
• CIVIL ENGINEER AND OWNER'S REPRESENTATIVE  
• TOWN OF CHAPEL HILL URBAN FORESTER: (919) 969-5114  
• ORANGE COUNTY SOLID WASTE STAFF: (919) 968-2788  
• ORANGE COUNTY EROSION CONTROL OFFICER: (919) 245-2587

SIGNS SHALL BE OF AN APPROVED SIZE, WEATHER RESISTANT AND MAINTAINED UNTIL REPLACED BY PERMANENT SIGNS.

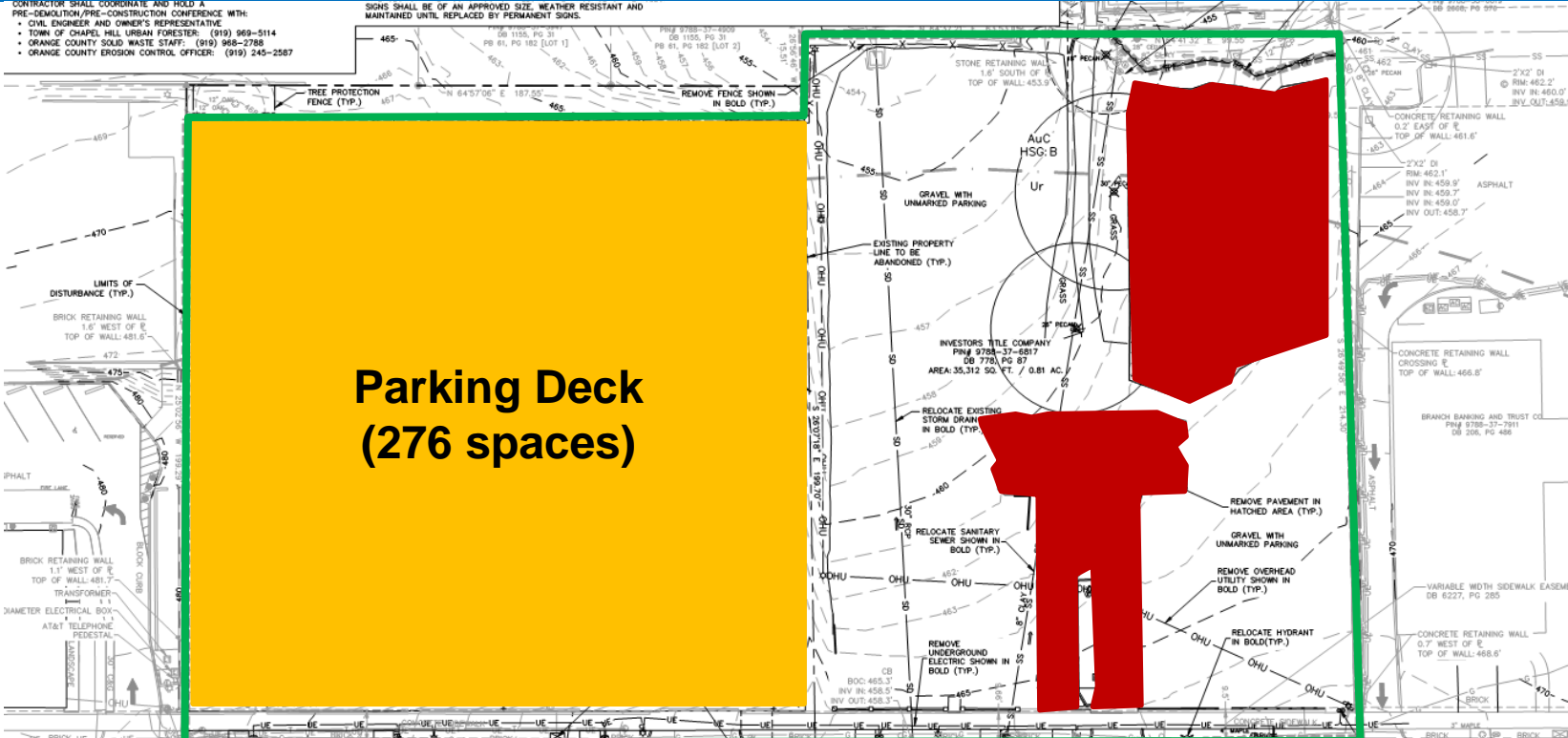

**Parking Deck  
(276 spaces)**

**Rosemary St**

# 125 E Rosemary St – Concept Plan

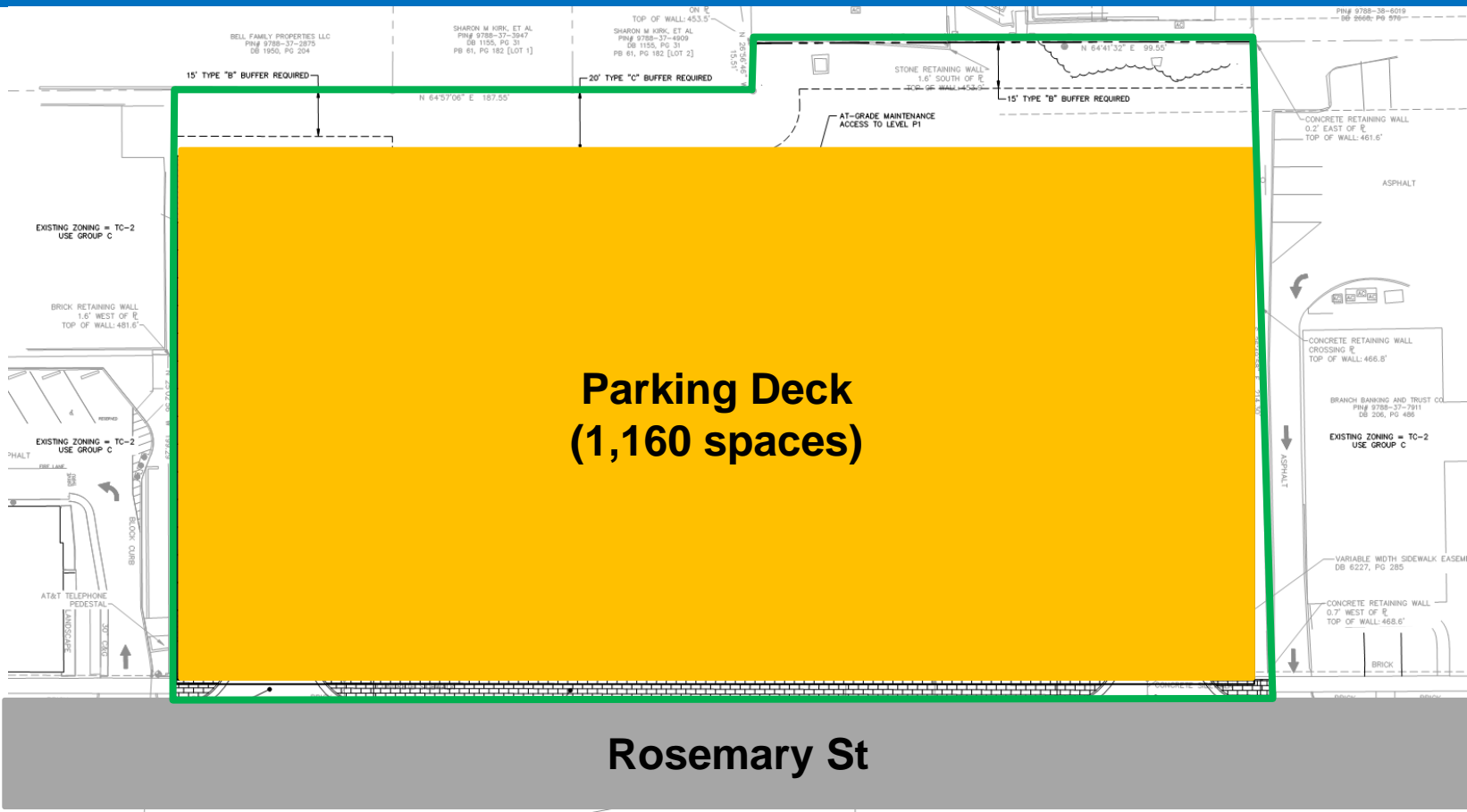

- Community Design Commission –  
April 2, 2020



- Adopt Resolution R-8, transmitting comments to the Applicant regarding the proposed development.