

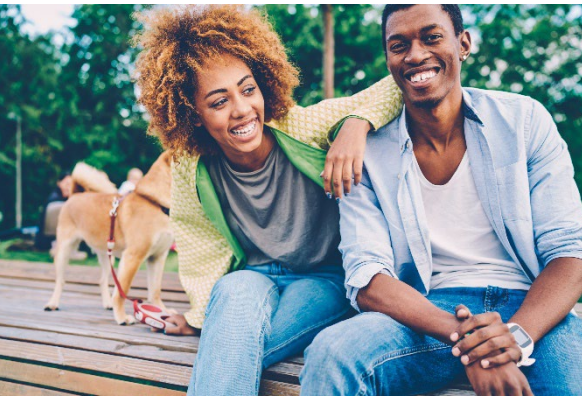

# Link Apartments® Rosemary



**GRUBB**  
PROPERTIES  
People who care. Places that matter.





# Purpose

The purpose of this project is to continue the successful redevelopment of the 100 block of E. Rosemary Street. Link Apartments® Rosemary will provide much-needed essential housing for young professionals working in the downtown innovation district.

# The Request:

SETBACK HEIGHT VS CORE HEIGHT

Current Setback Height

Core Height

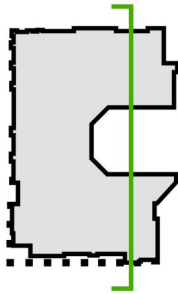

Current Setback Height

Core Height

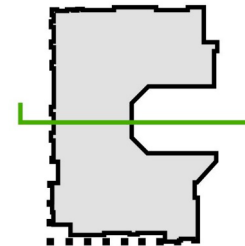

# Design Concept

## ELEVATION & AXON IN CONTEXT



E. ROSEMARY ST ELEVATION



# Rosemary Street Front Activation

Majority of Rosemary frontage is available for affordable retail.

Additional retail to be available on lowest level of Columbia Frontage.

Cycle Center is now interior to the building.

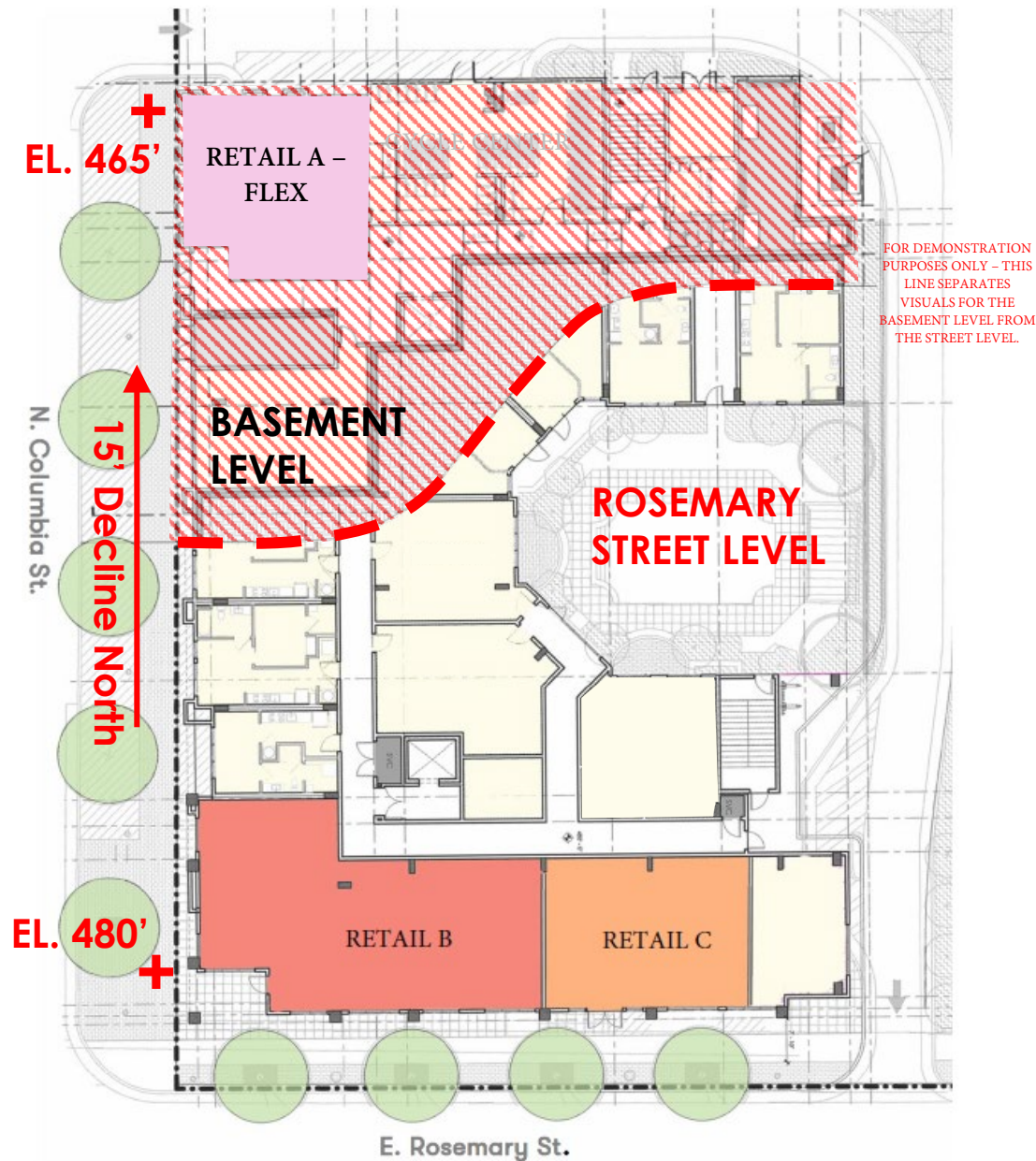

# Link Apartments® Rosemary



DECEMBER 07, 2022

# Link Apartments® Rosemary

## Retail Areas

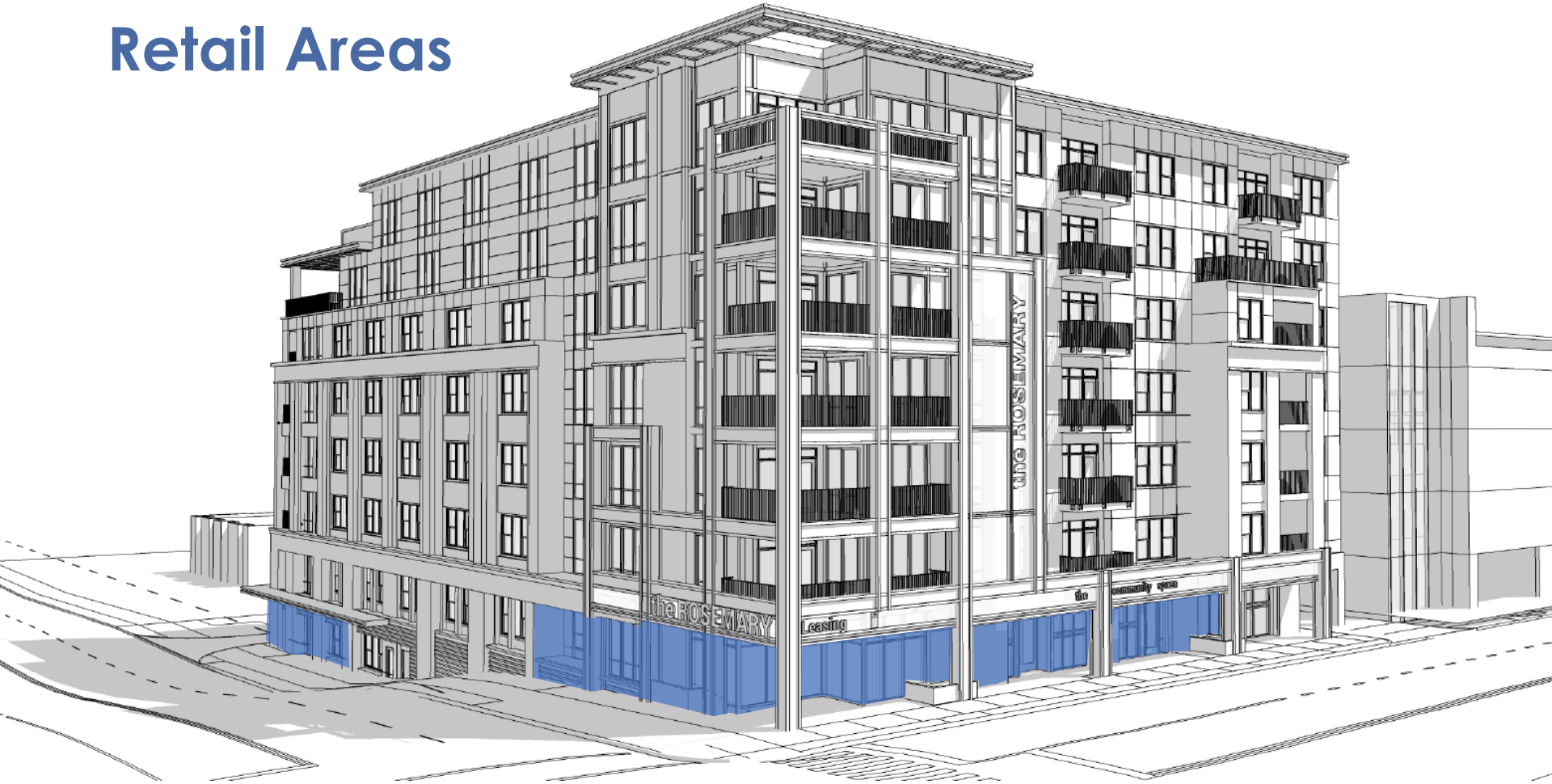

# Affordability Strategy

101 E Rosemary will include retail on Columbia and Rosemary Streets.

The retail leasing team will work with economic development programs to identify local retailers as potential tenants of retail space.

Local retailers with a demonstrated financial need will be offered a below-market affordable rent.



Boutique



Salon



Community Space



Dining



# Rosemary Street Front Activation

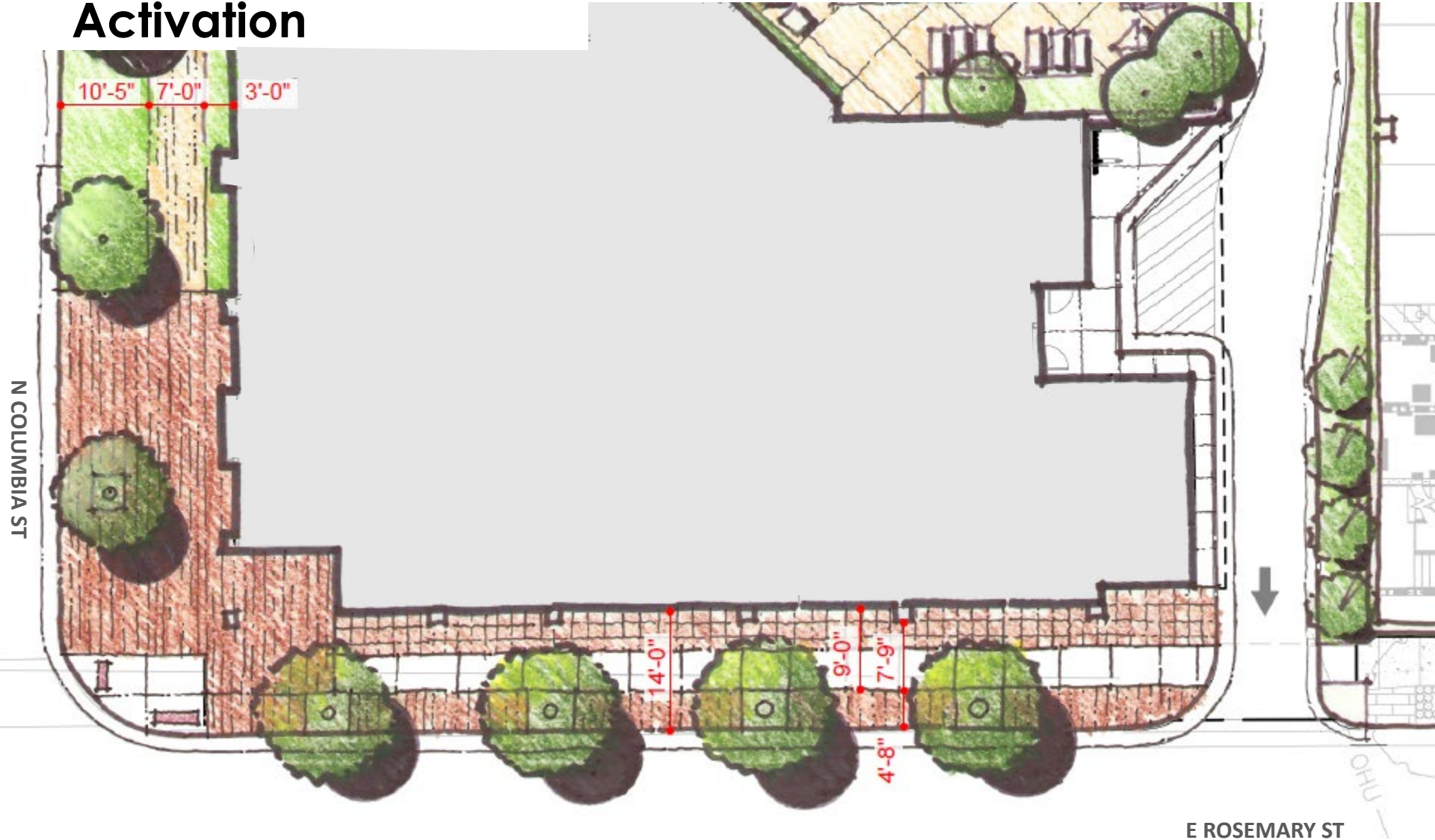

# Link Apartments® Rosemary

Looking East on  
Rosemary



DECEMBER 07, 2022

# Link Apartments® Rosemary

Looking West on  
Rosemary



DECEMBER 07, 2022

# Link Apartments® Rosemary

Looking North on  
Columbia



DECEMBER 07, 2022

**BB+M**  
ARCHITECTURE

# Link Apartments® Rosemary

**Thank you**