

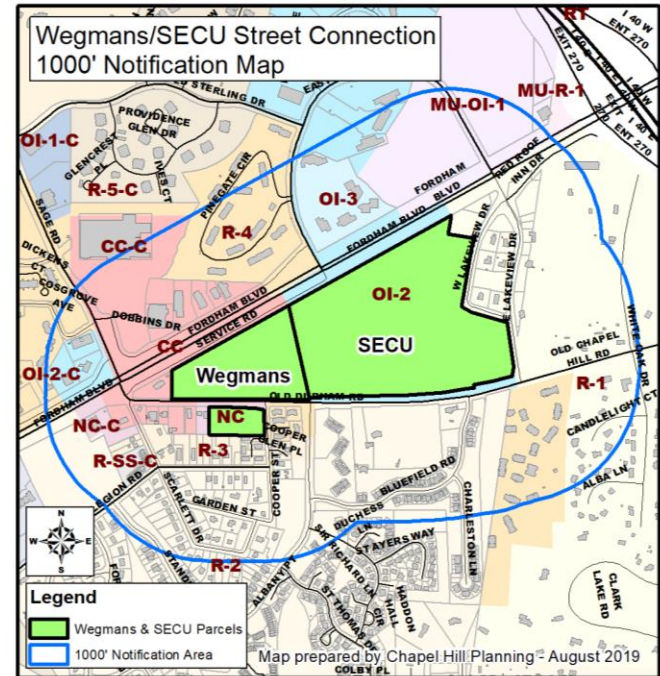

# Wegmans/SECU Street Connection Connection Concept Plan

Town Council  
September 11, 2019

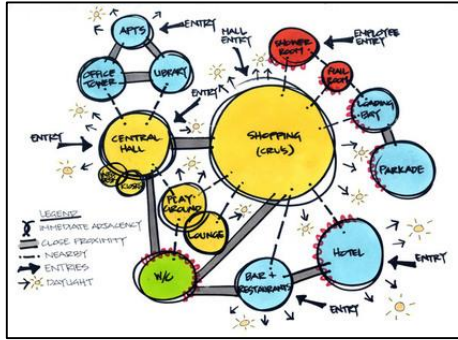



## Concept Plans

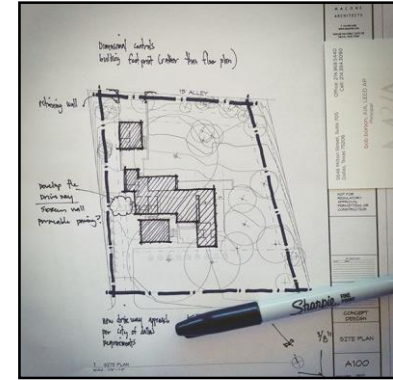

- **No Decision; Feedback Only**
  - Applicant presents rough initial sketch
  - Staff does not conduct formal review of concept
  - Instead forwards sketch for preliminary feedback

# Next Step in Process: Submit Formal Development Application

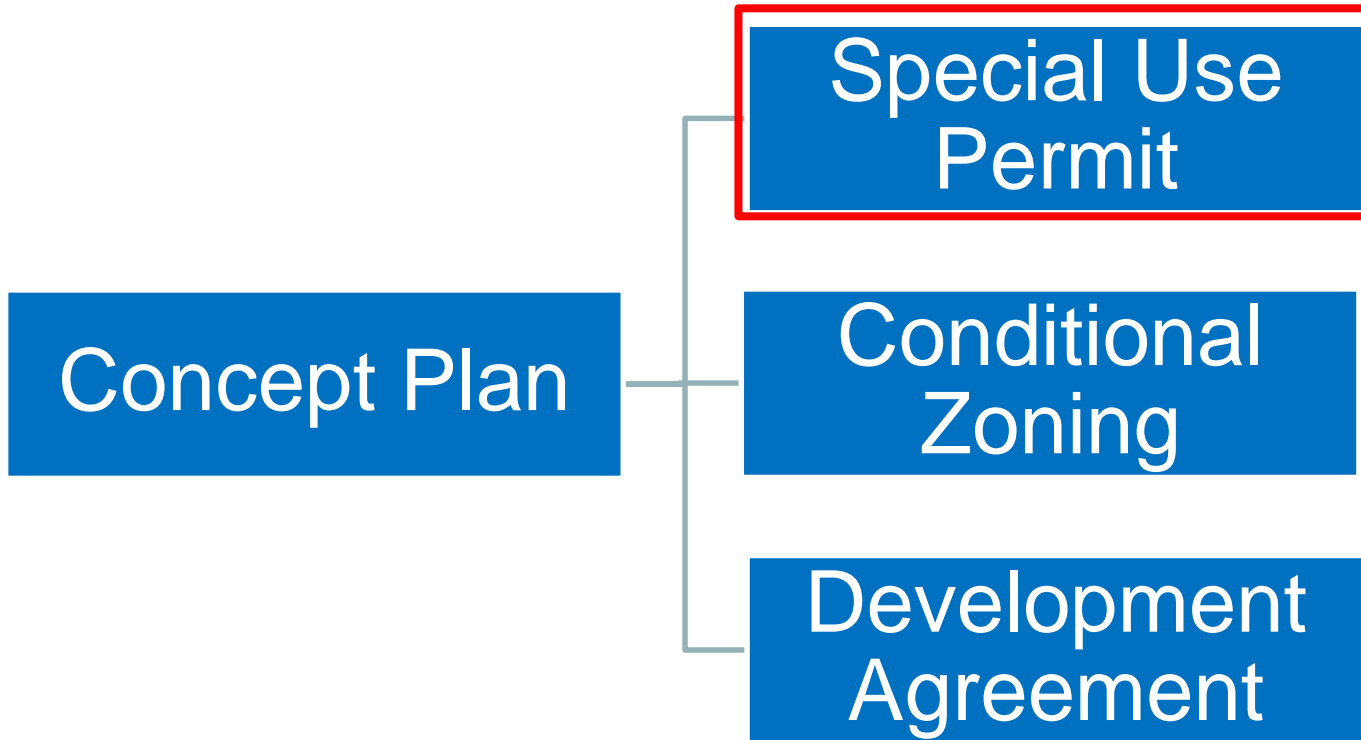

- Adopt Resolution R-9, transmitting comments to the Applicant regarding the proposed development.

# Wegmans/SECU – Project Summary

- Wegmans SUP approved in October 2017, up to:
  - 130,000 SF building
  - 750 parking spaces
- Full access limited to Old Durham Rd traffic circle
- Traffic calming measures required on adjacent streets

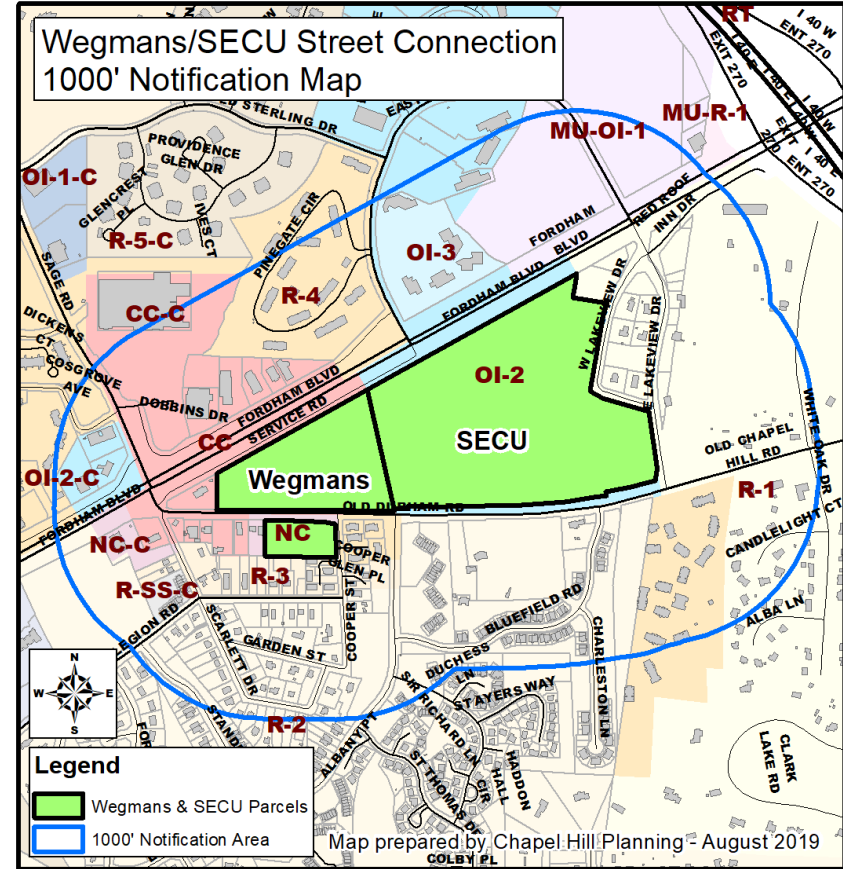

# Wegmans/SECU – Existing Conditions

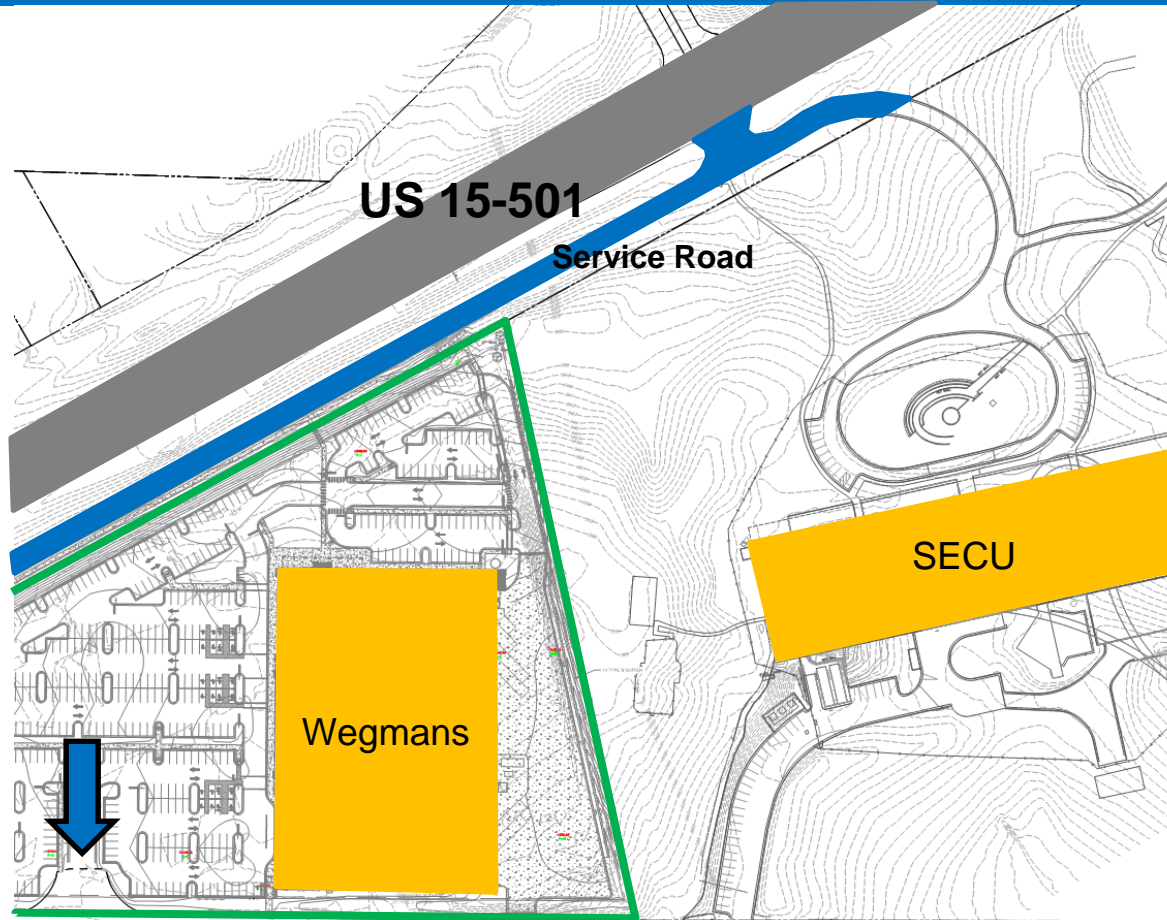

# Wegmans/SECU – Concept Plan

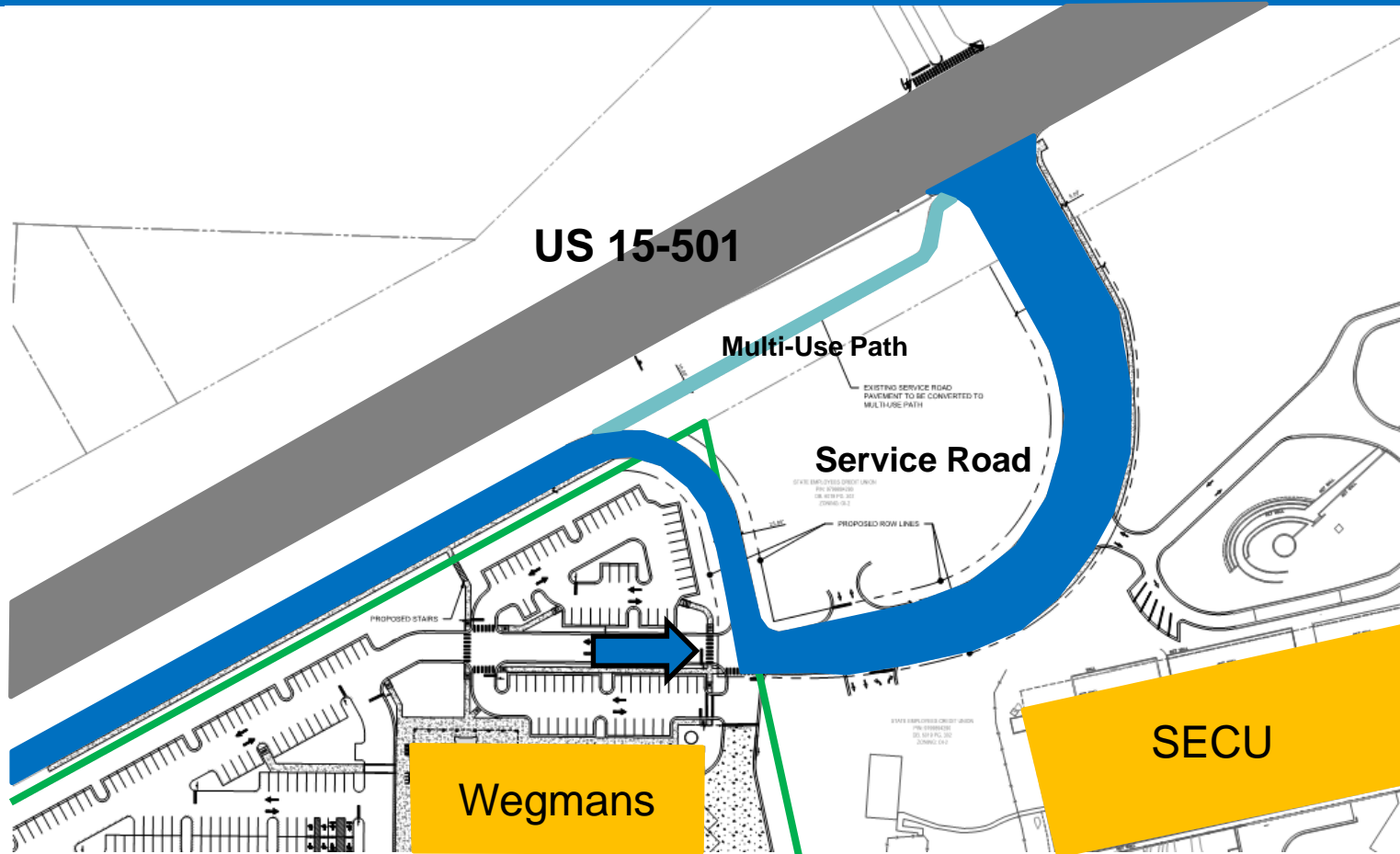

- Community Design Commission – August 27<sup>th</sup>
- Transportation and Connectivity Advisory Board – August 27<sup>th</sup>



- Adopt Resolution R-9, transmitting comments to the Applicant regarding the proposed development.